

1YYASC53/1PPASC53



180 min



x2

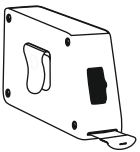
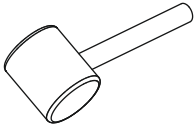
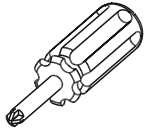
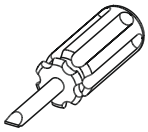

~42,5 cm

~90,8 cm

~161,1 cm

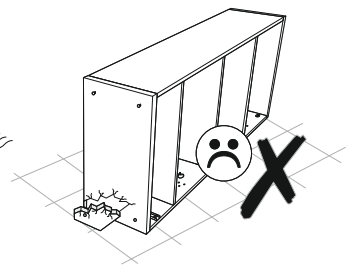
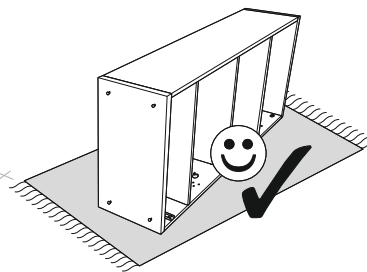
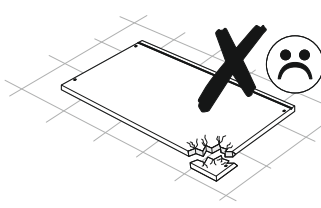
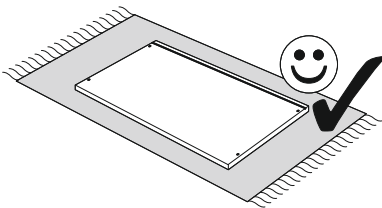
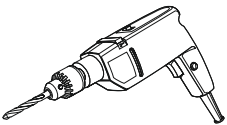
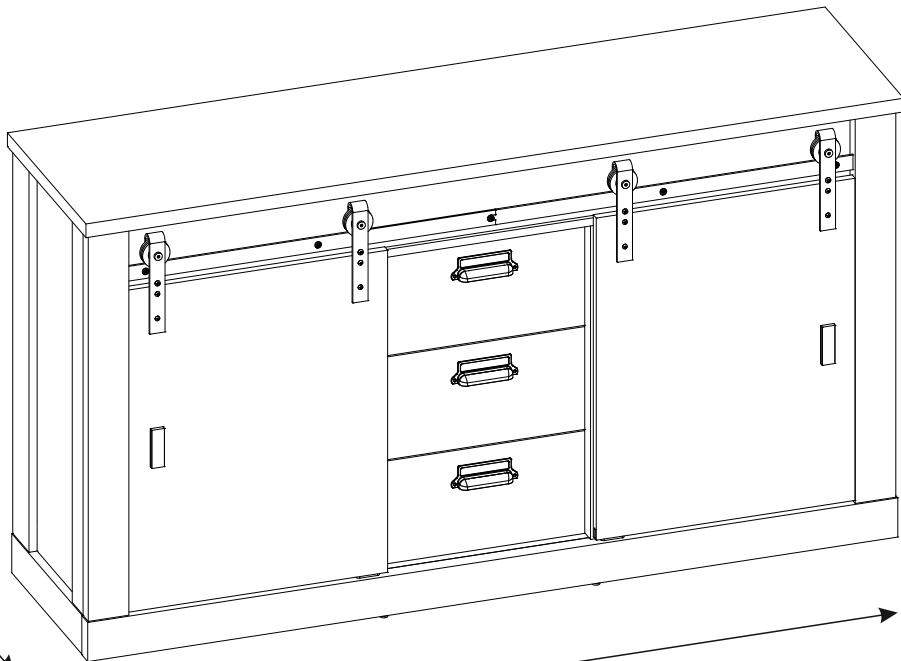

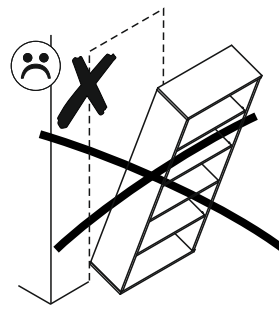
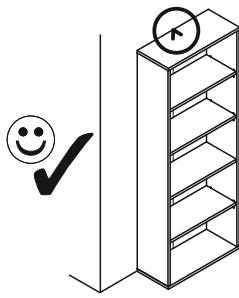

PL.

UWAGA! Mebel należy trwale zamocować do ściany, aby uniknąć ryzyka związanego z przewróceniem się mebla.

W paczce nie ma śrub mocujących, ponieważ rodzaj mocowania należy odpowiednio dobrać do rodzaju ściany. Dobierz właściwe do Twojego rodzaju ściany.

D.

ACHTUNG! Um alle mit dem Umkippen des Möbels verbundenen Risiken auszuschließen, muss das Möbel fest an der Wand verankert werden. Beschläge für die Wandbefestigung sind nicht beige packt, da diese von der jeweiligen Wandbeschaffenheit abhängig sind. Bitte solche Befestigungsschläge wählen, die für die heimischen Wände geeignet sind.

FR.

ATTENTION! Ce meuble doit être fixé en permanence au mur pour éviter les risques de chute. Les vis de fixation ne sont pas livrées car le type de fixation doit être choisi en fonction du type de mur. Sélectionnez les fixations adaptées au mur.

I.

ATTENZIONE! Il mobile deve essere permanentemente fissato alla parete per evitare i rischi derivanti da un ribaltamento del mobile. La confezione non include le viti di fissaggio, in quanto il tipo di fissaggio deve essere scelto in base al tipo di parete. Utilizzare viti appropriate in base al materiale della parete.

HR.

NAPOMENA! Namještaj mora biti trajno pričvršćen za zid, kako bi se izbjegao rizik od njegova prevrtanja. U paketu nema vijaka za pričvršćivanje, jer se vrsta montaže mora prilagoditi vrsti zida. Odaberite pravu vrstu prema Vašoj vrsti zida.

EN.

WARNING! To prevent this furniture from tripping over, fix it to the wall permanently. Fixing devices are not included since different wall materials require different types of fixing devices. Please make sure you chose the correct ones for your type of wall.

SK.

POZOR! Nábytok musí byť trvalo pripevnený k stene tak, aby sa zamedzilo riziku prevrátenia. Balík neobsahuje upevňovacie skrutky, pretože typ upevnenia je treba vybrať podľa typu steny. Vyberte typ vhodný pre Vašu stenu.

CZ.

POZOR! Nábytek je nutné pevně připevnit ke zdi, abychom se vyhnuli riziku spojenému s jeho převrnutím. Součástí balení nejsou připevňovací šrouby, protože způsob připevnění je nutné zvolit podle druhu stěny. Vyberte správný pro Váš typ stěny.

RU.

ПРИМЕЧАНИЕ! Эту мебель необходимо всегда прикреплять к стене, чтобы избежать рисков, связанных с переворотом мебели. В пакете нет крепежных винтов, потому что тип крепления должен быть выбран в соответствии с типом стены. Выберите, пожалуйста, правильные винты к вашей стене.

RO.

ATENȚIE! Mobila trebuie ancorată permanent în perete pentru a evita riscul de răsturnare a mobilei. În pachet nu sunt incluse șuruburile de fixare, deoarece tipul de ancoraj trebuie ales în funcție de tipul de perete. Alegeți șuruburile potrivite pentru tipul Dvs. de perete.

TR.

DİKKAT! Devrilmeye riskini önlemek için mobilya duvara sabitlemelidir. Sabitleme civataları pakete dahil değil, çünkü sabitleme tertibatının tipi, duvara tipine uygun olarak seçilmelidir. Onu duvarınızın tipine göre seçiniz.

AR.

ملاحظة!

يجب تثبيت الأثاث بإحكام إلى الحائط أو الجدار لتجنب خطر إنقلابه. لا تحتوي اللعبة على مسامير التثبيت، إذ إنه ينبغي إستعمال المسامير المخصصة لنوعية الحائط أو الجدار. اختر المسامير التي تناسب جدارك.

E.

¡ATENCIÓN! El mueble debe ser fijado permanentemente a la pared para evitar el riesgo relacionado con el vuelco del mueble. En el paquete no hay tornillos de fijación, ya que se debe elegir el tipo de fijación adecuado para el tipo de pared. Elija el apropiado para su tipo de pared.

CN.

注意！本家具需要固定在墙上以免倒塌。箱子里没有安装螺钉。因为安装方式需要根据墙的类型调整。请按照您的墙类型选择合适的安装方式。

SLO.

POZOR! Pohištvu trajno pritrdite na steno, da preprečite tveganje, da se prevrne. V paketu ni pritrdilnih vijakov, saj je treba način pritrditve ustrezno izbrati glede na vrsto stene. Izberite način, ki je ustrezen za vašo steno.

HU.

FIGYELEM! Rögzítse a bútorokat a falhoz, hogy elkerülje a bútor felborulásának kockázatát. A készletben nem találhatóak rögzítőcsavarok, mivel a rögzítés típusa a fal típusától függ. Válassza ki a fal típusának megfelelő kötőelemeket.

NL.

OPMERKING! De meubelen moeten permanent aan de muur worden bevestigd om te voorkomen dat de meubelen kantelen. Er zitten geen bevestigingsschroeven in het pakket, omdat het type bevestiging moet worden gekozen op basis van het type muur. Kies de juiste voor uw type muur.

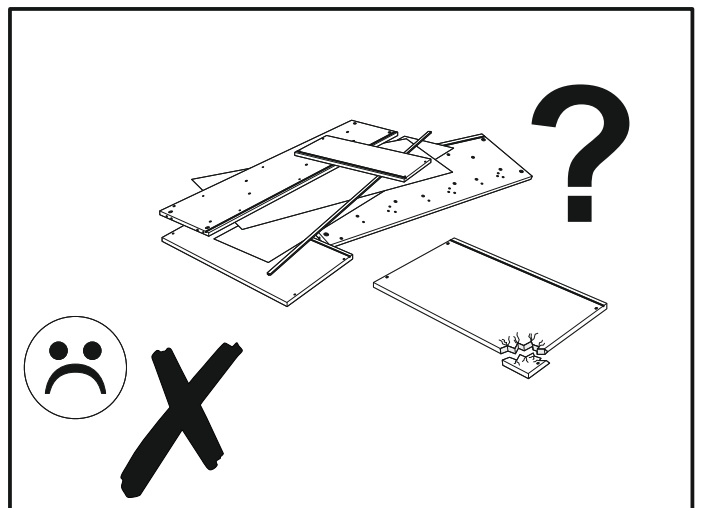
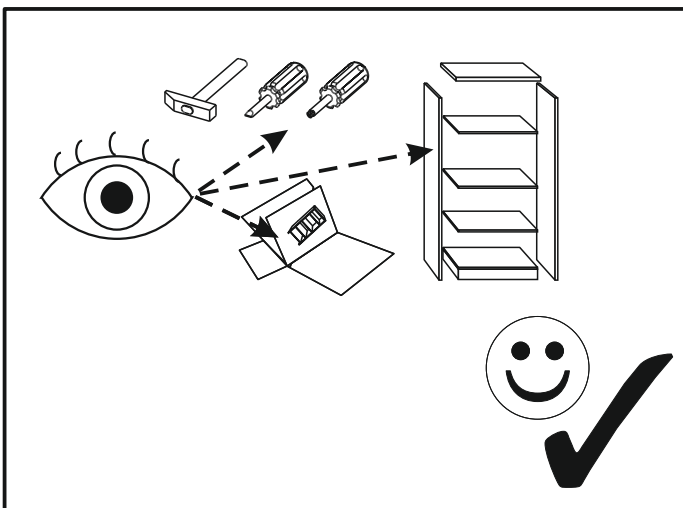
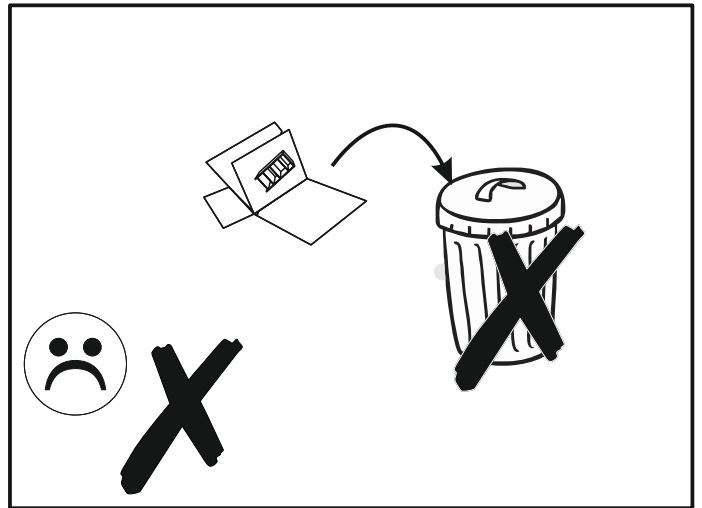
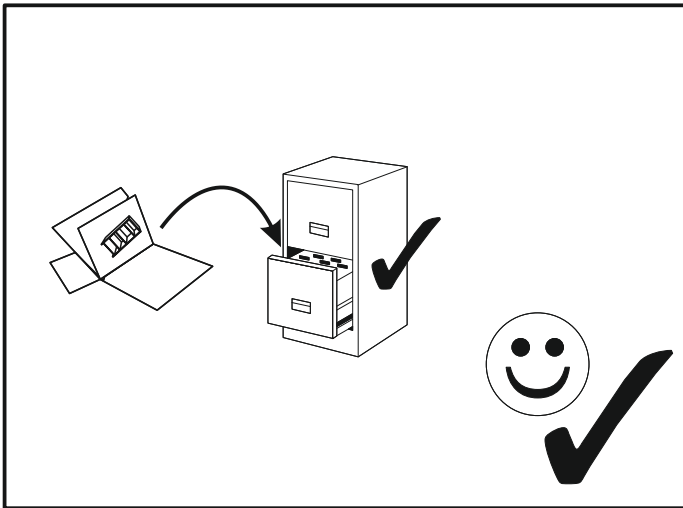
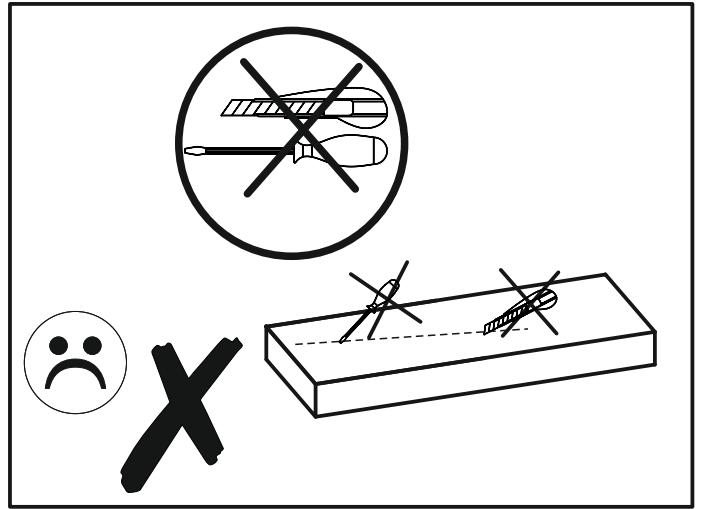
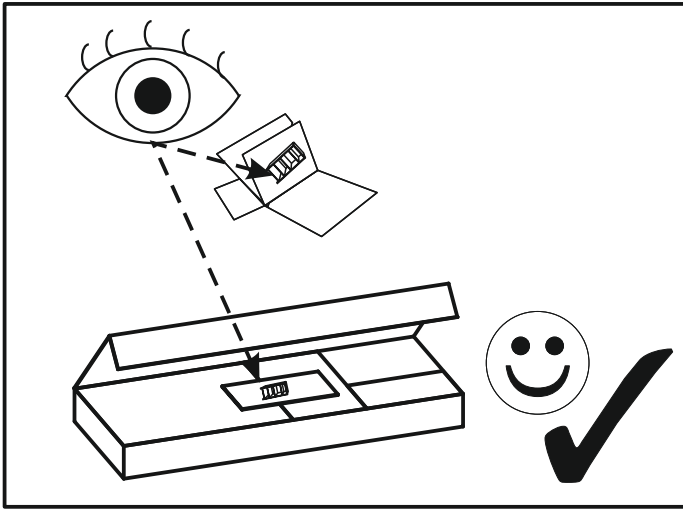

1YYASC53/1PPASC53

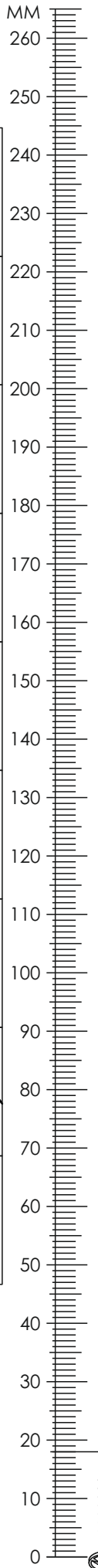

A0	8 x 20 mm	x12	A1	8 x 35 mm	x85	C2	5 x 13 mm	x12
D2		x16	E0	Ø16	x18	E1	15 x 12 mm	x50
F1	6 x 34 mm	x50	G1	7 x 50 mm	x10	H1	L - 131 mm	x3
H2	L - 78 mm	x2	I0	3 x 13 mm	x4	I2	4 x 16 mm	x2
K3	M4 x 22mm	x10	M		x1	M1		x1
N1	3 x 16 mm	x45	N14	4 x 30 mm	x12	O2		x8
P16		x8	Q1		x2	Q9		x2
R1		x8	R4		x7	R8		x2
R10		x2	S17		x8	T10		x3
Z		x1						

1YYASC53/1PPASC53

BE SC 14 28 00

x1

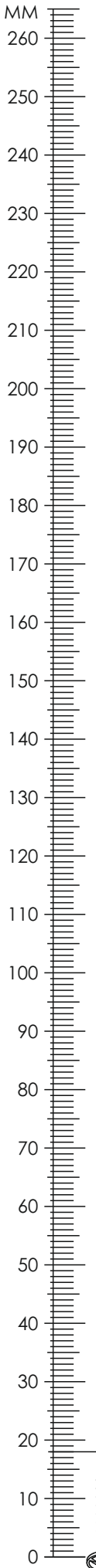
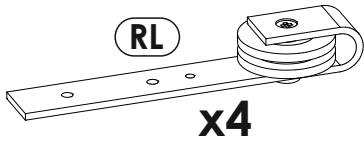
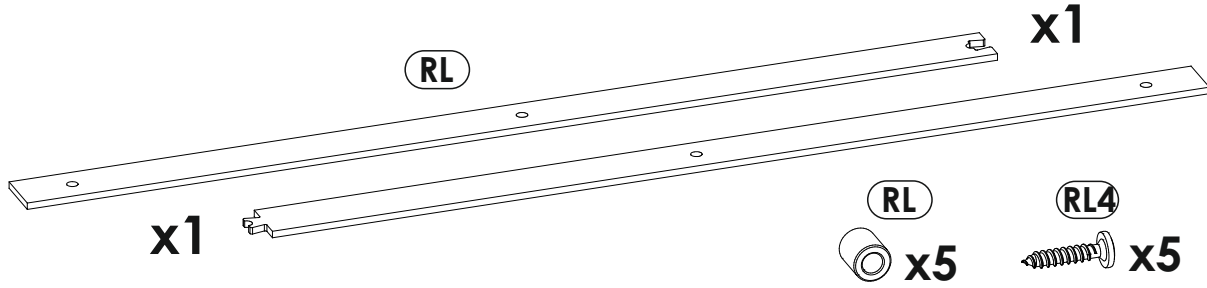

1YYASC53/1PPASC53

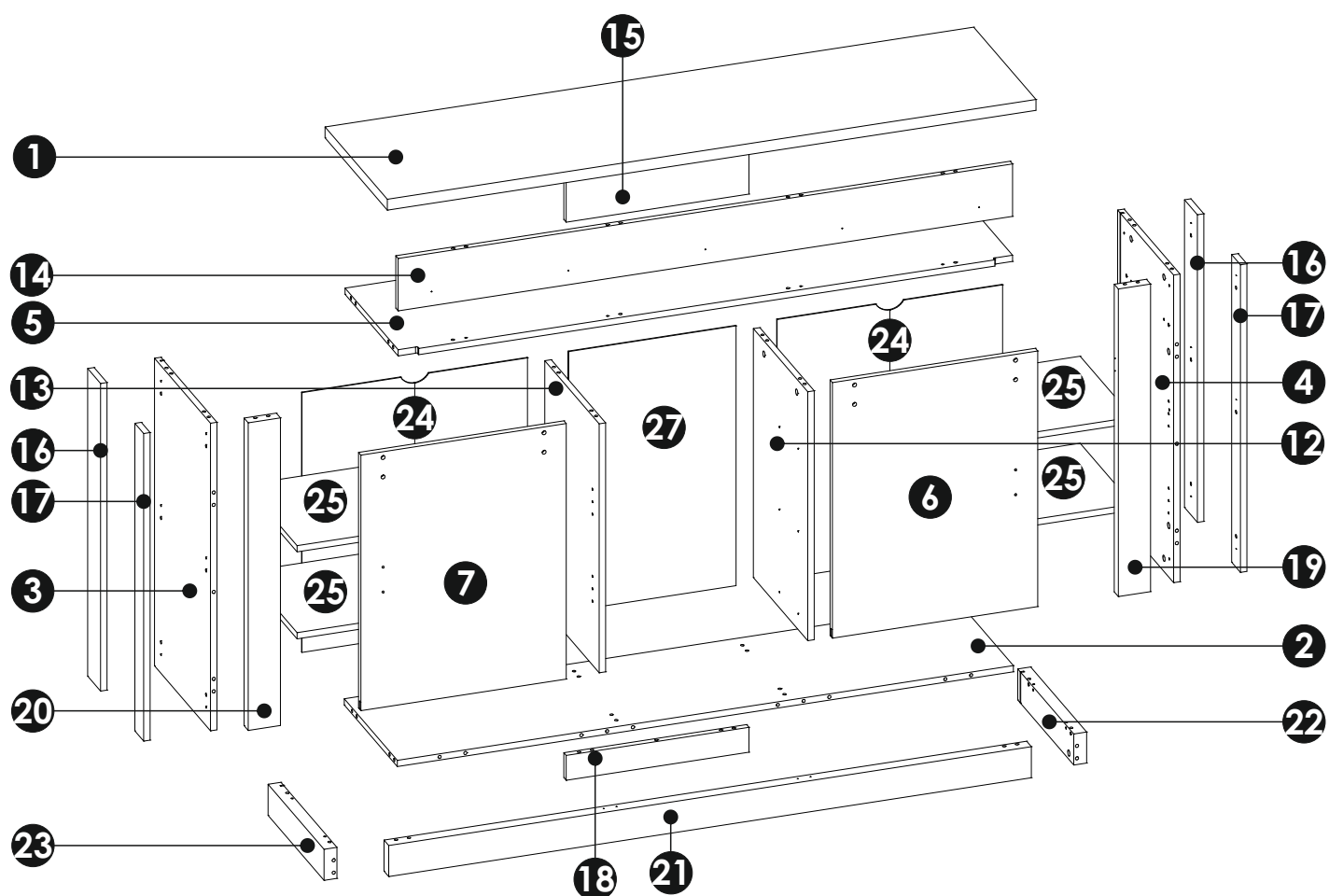
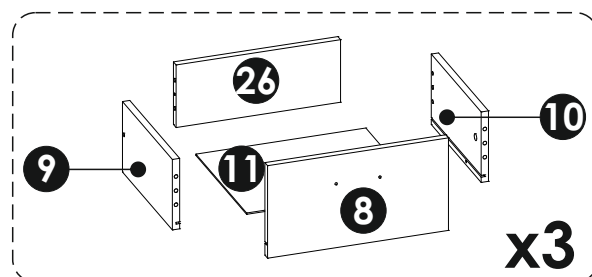
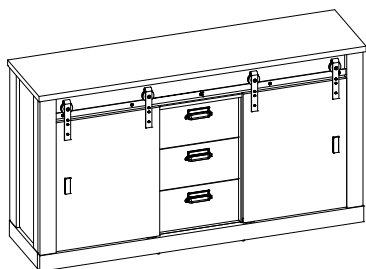

1	1611	425	28	x1	3/3
2	1530	362	16	x1	3/3
3	792	382	16	x1	1/3
4	792	382	16	x1	1/3
5	1526	372	16	x1	2/3
6	658	510	16	x1	2/3
7	658	510	16	x1	2/3
8	396	210	16	x3	3/3
9	300	160	16	x3	1/3

10	300	160	16	x3	1/3
11	372	305	3	x3	2/3
12	641	371	16	x1	2/3
13	641	371	16	x1	2/3
14	1526	135	16	x1	2/3
15	454	135	16	x1	2/3
16	792	88	16	x2	3/3
17	792	60	16	x2	3/3
18	454	64	16	x1	2/3

19	792	80	28	x1	1/3
20	792	80	28	x1	1/3
21	1596	80	32	x1	3/3
22	382	80	32	x1	2/3
23	382	80	32	x1	2/3
24	669	560	3	x2	2/3
25	545	358	16	x4	1/3
26	360	142	16	x3	1/3
27	669	416	3	x1	3/3

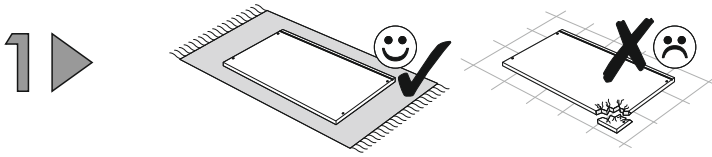
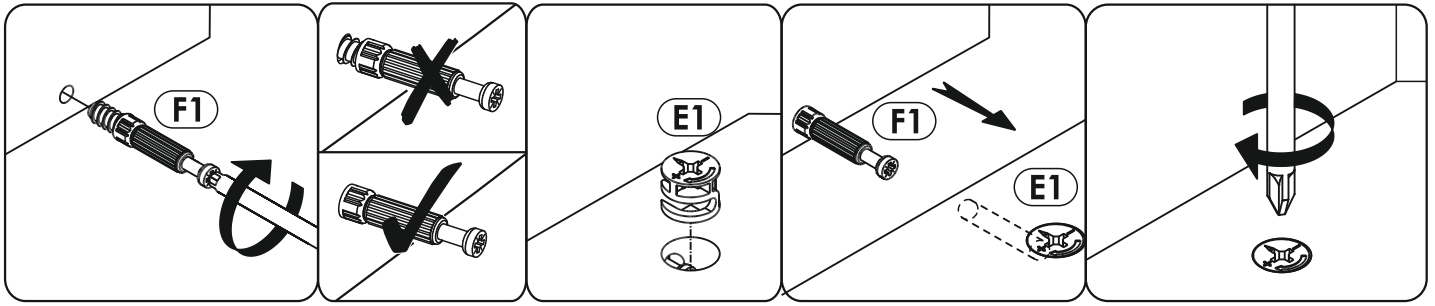

A1 x4 8 x 35 mm	C2 x6 5 x 13 mm	E1 x2 15 x 12 mm	T10 x3 L-310 mm
------------------------------	------------------------------	-------------------------------	------------------------------

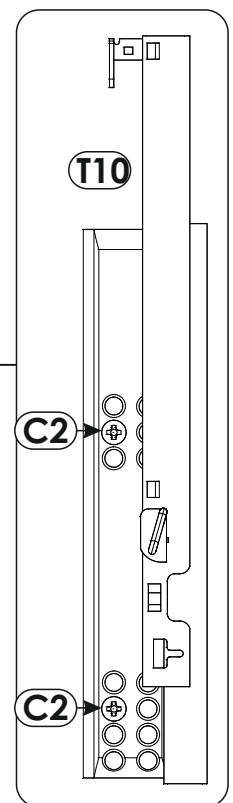
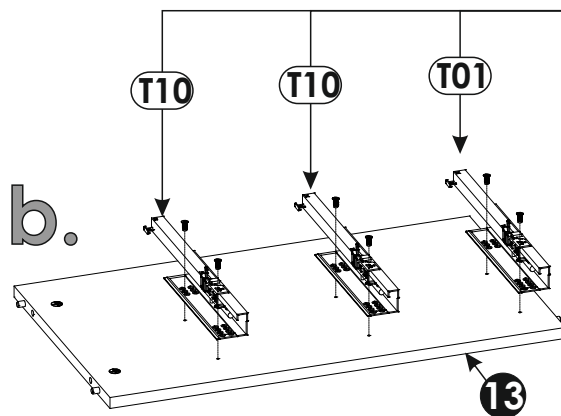
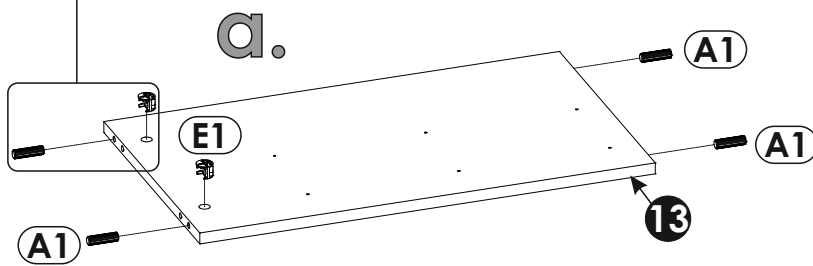
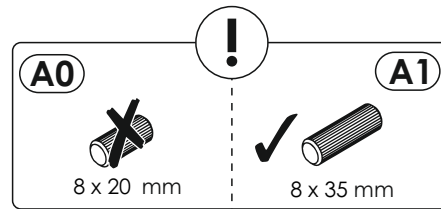
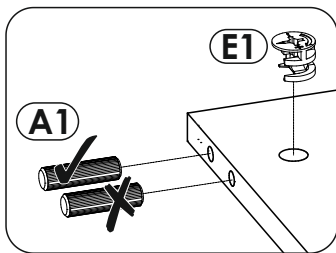

2 ▶

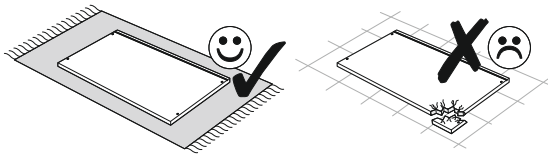

A1	x4	E1	x4	F1	x4
8 x 35 mm		15 x 12 mm		6 x 34 mm	

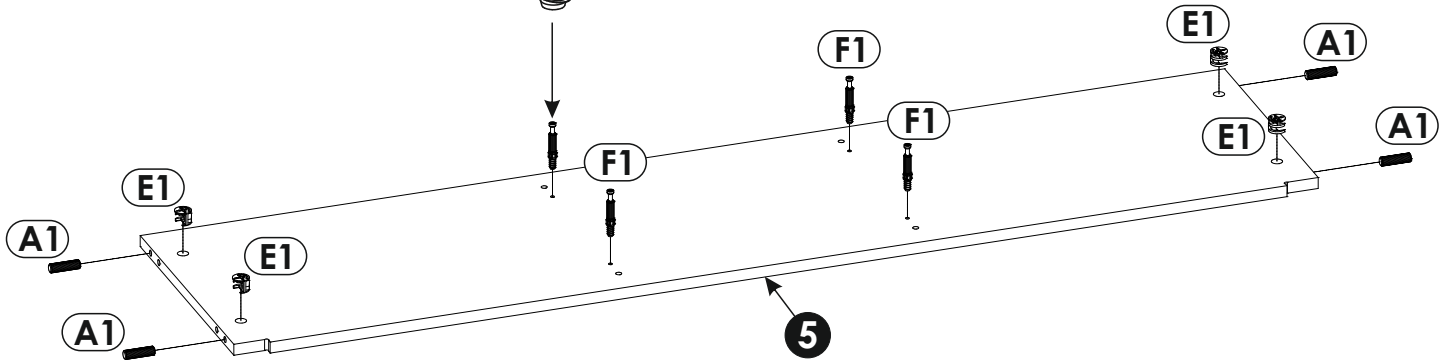
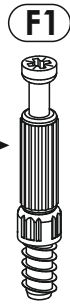
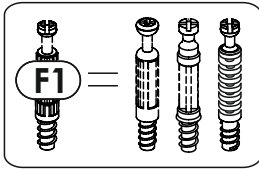
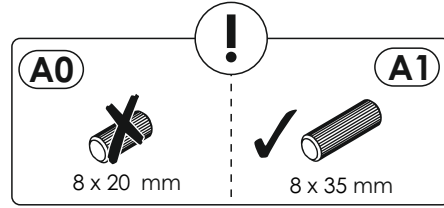

3 ▶

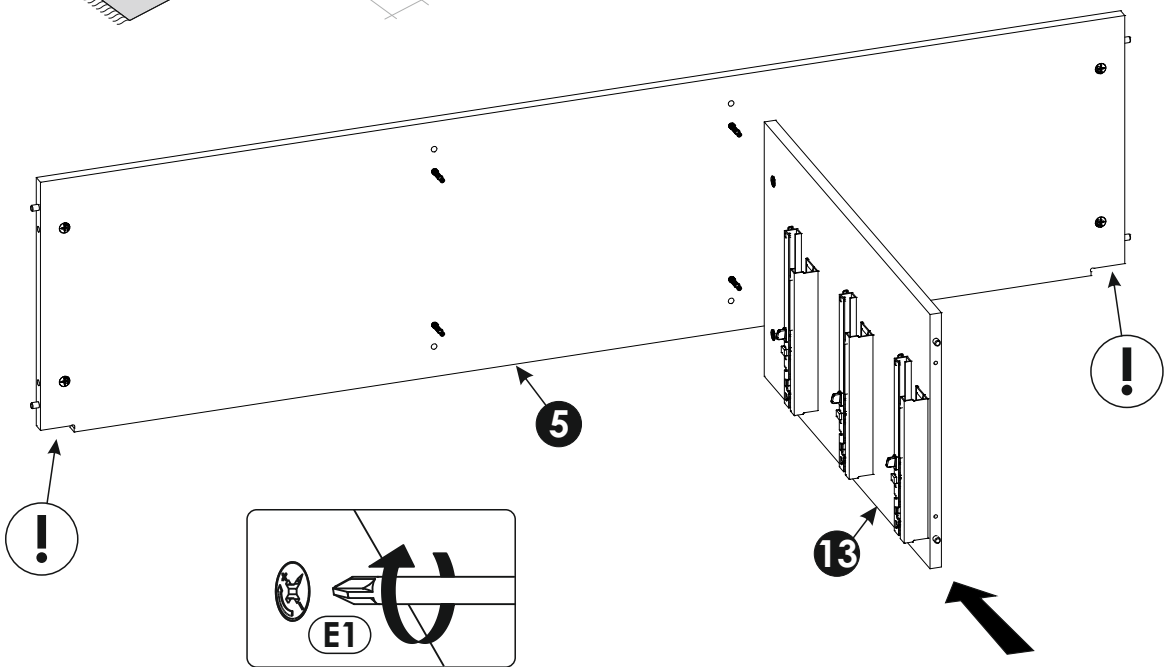
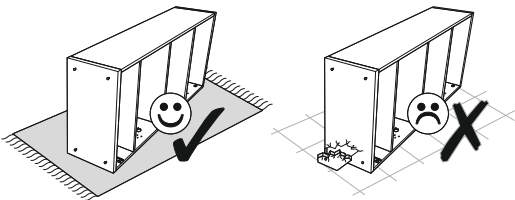

4 ▶

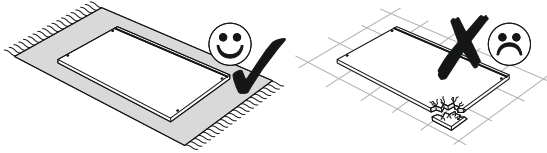

A1 x4 8 x 35 mm	C2 x6 5 x 13 mm
E1 x2 15 x 12 mm	T10 x3 L-310 mm

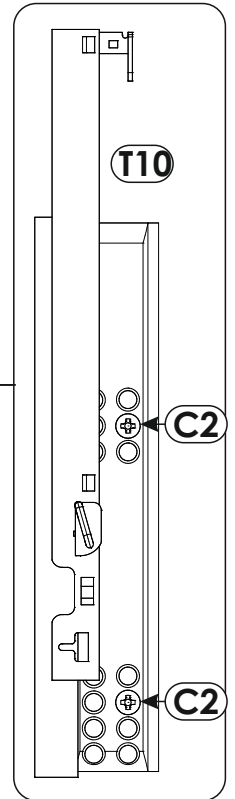
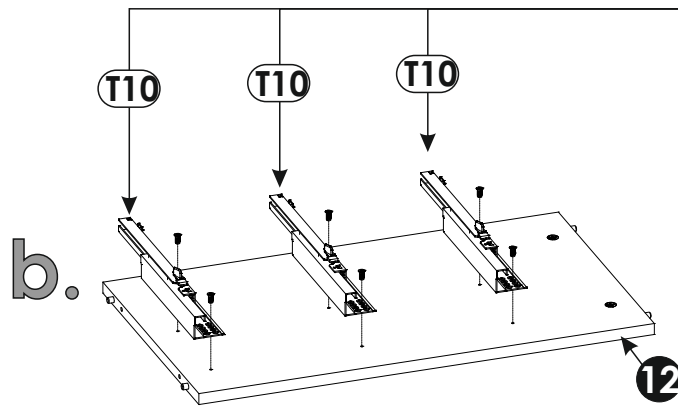
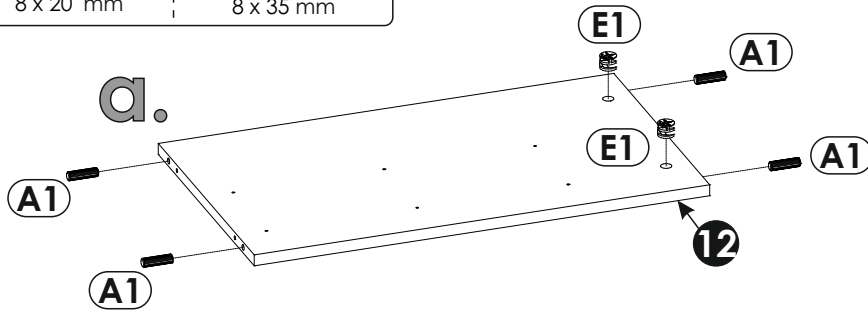
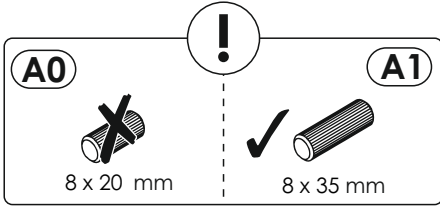

5 ▶

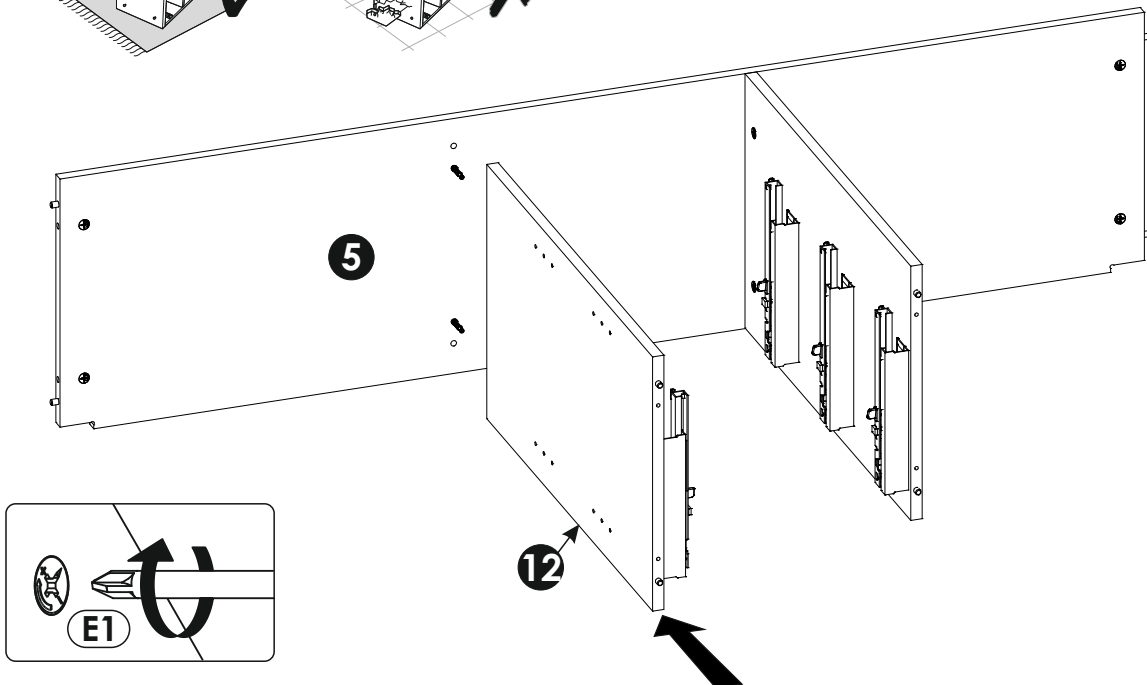
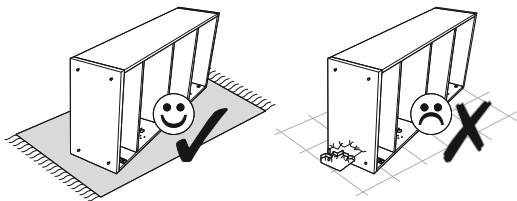

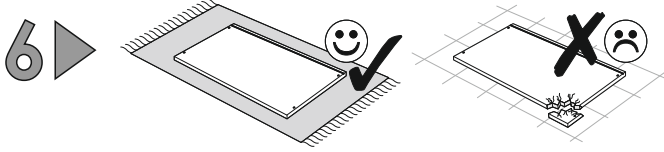

A1	x7	E1	x6	F1	x2
8 x 35 mm		15 x 12 mm		6 x 34 mm	

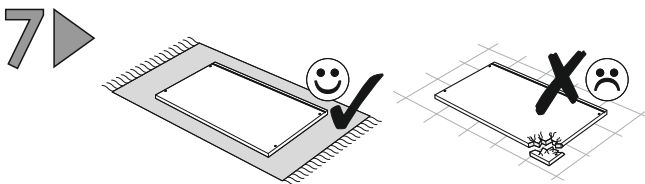
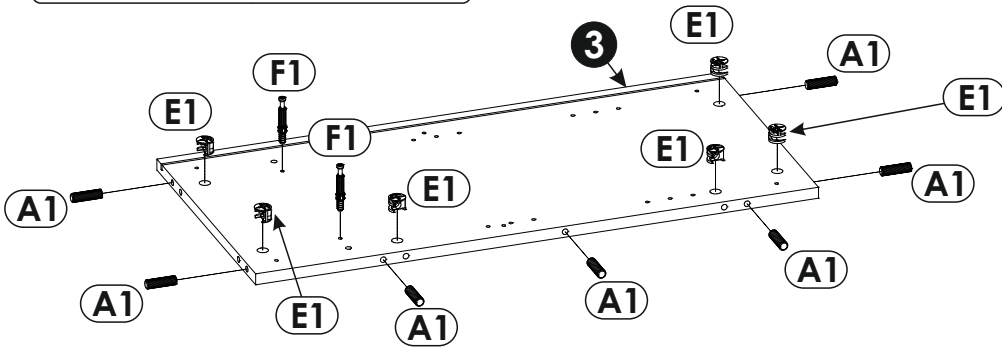
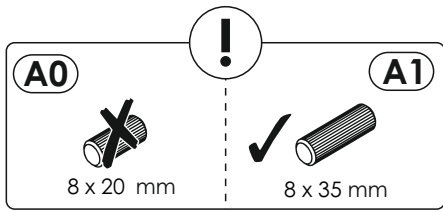

A0	x12
8 x 20 mm	

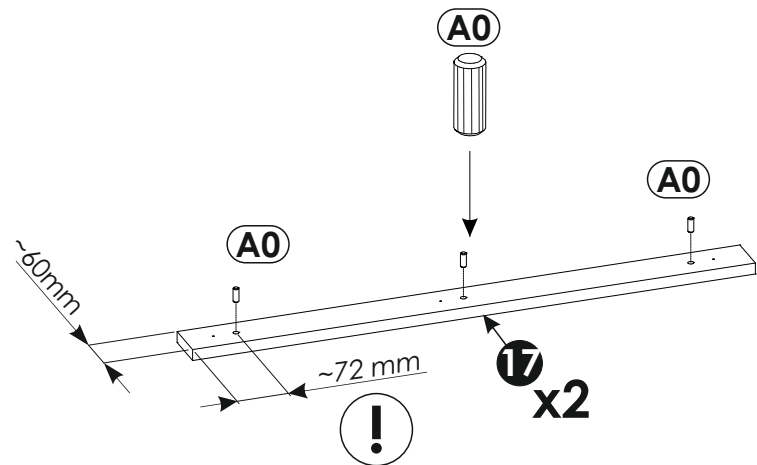
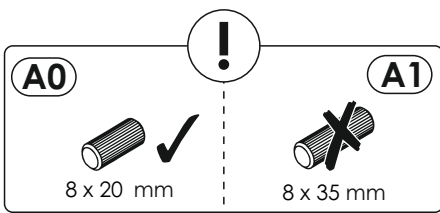
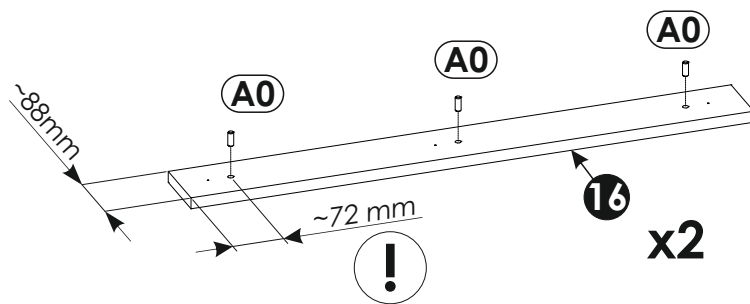

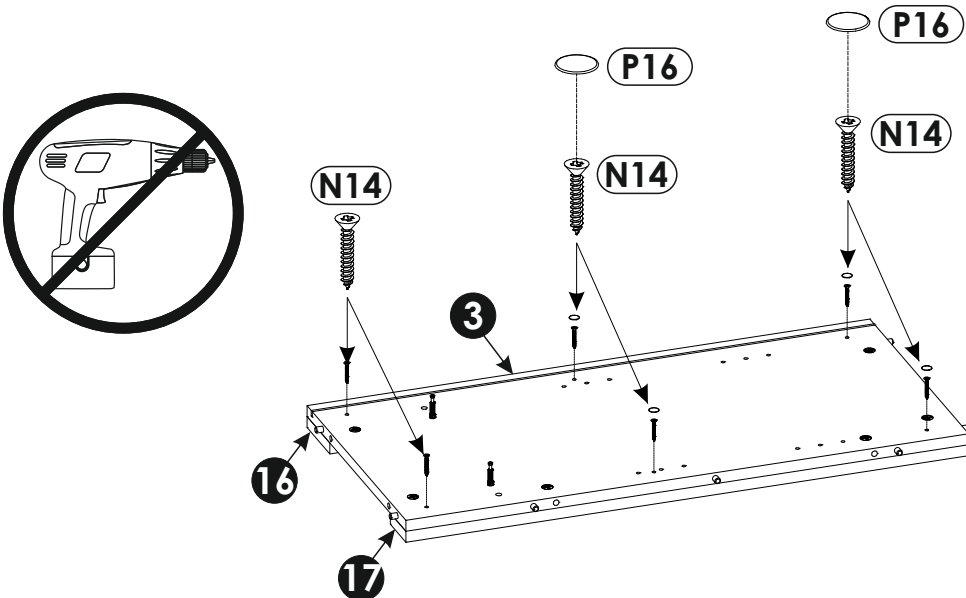
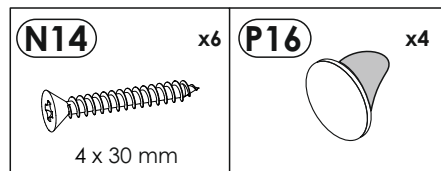
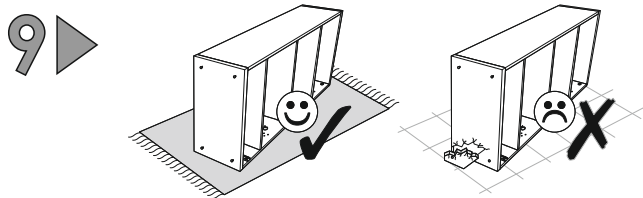
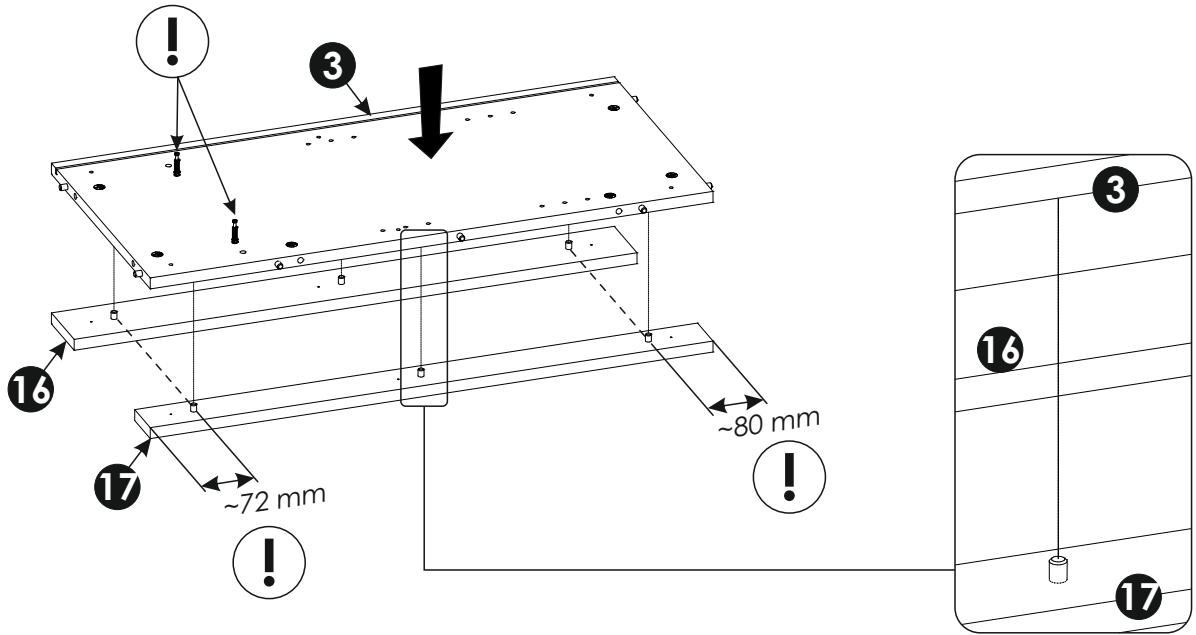
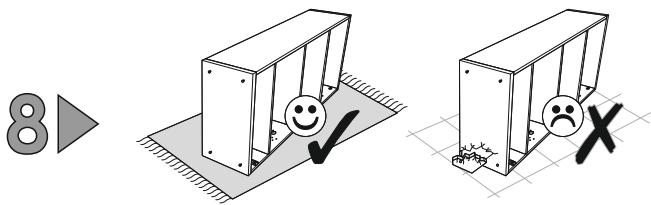

10 ▶

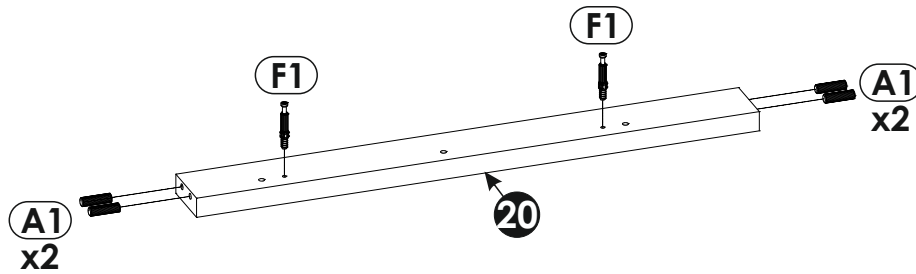
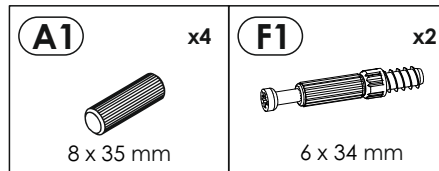
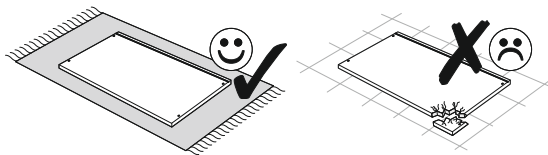

11 ▶

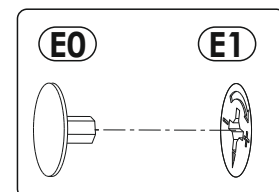
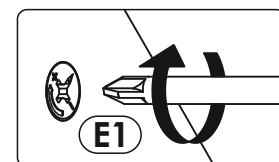
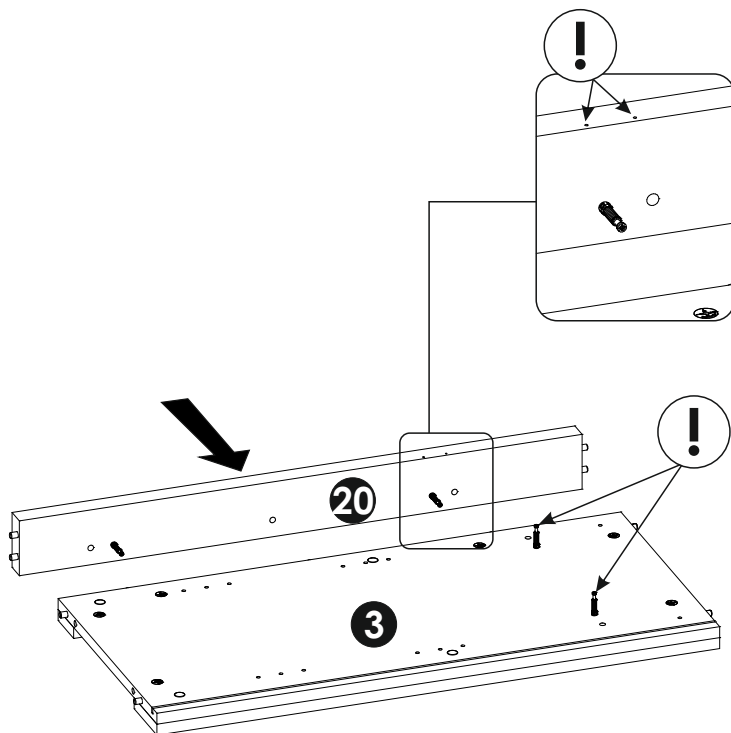
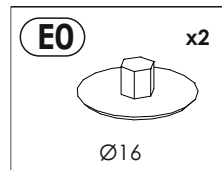
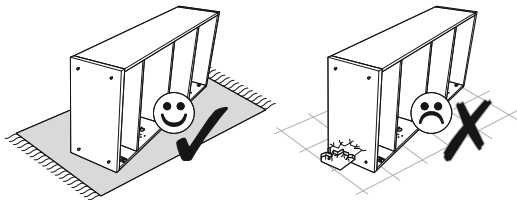

12 ▶

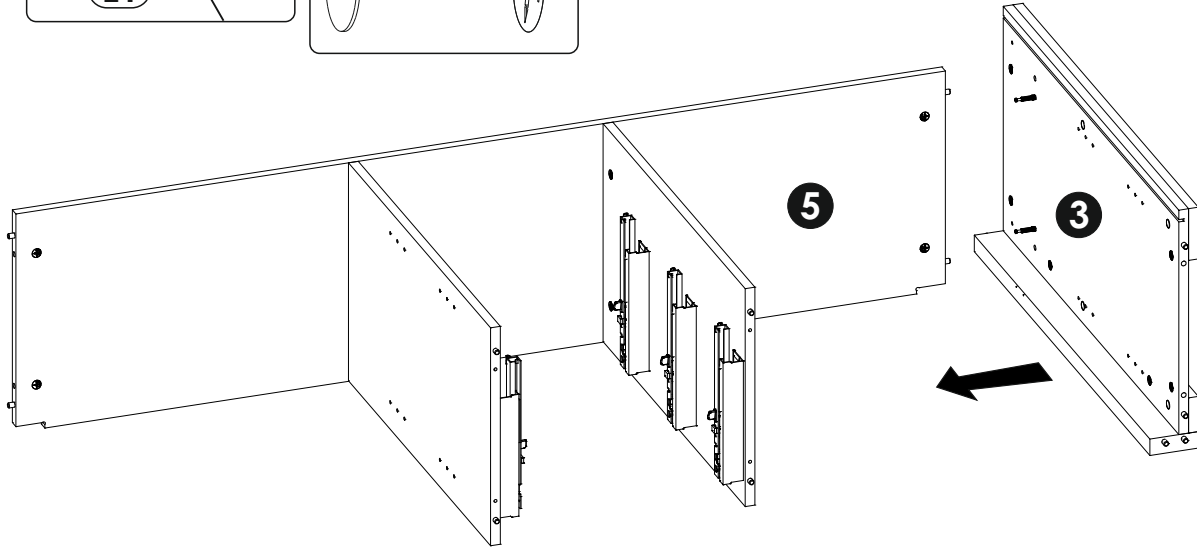
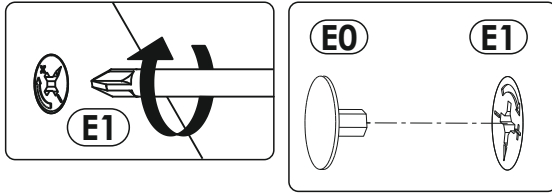
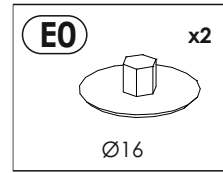
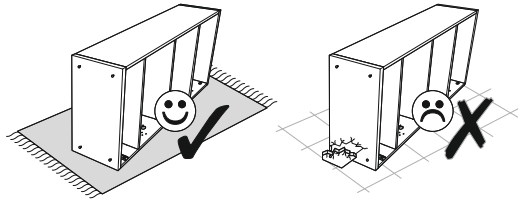

13 ▶

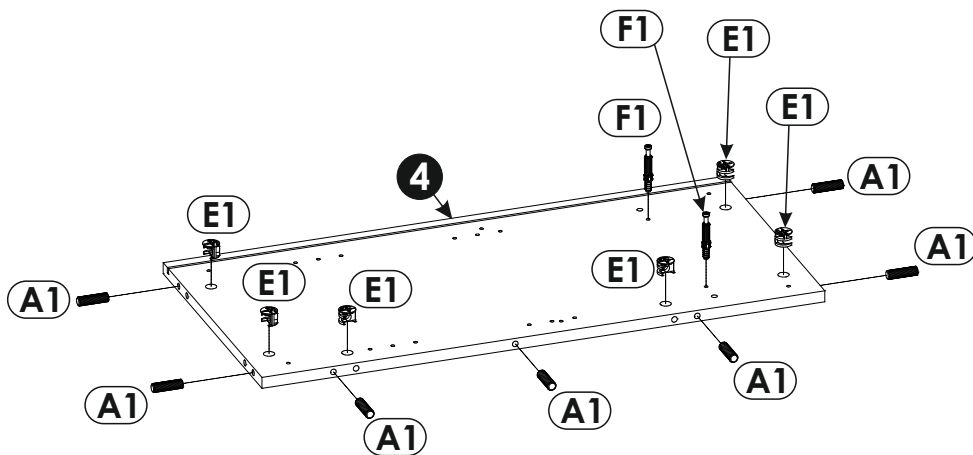
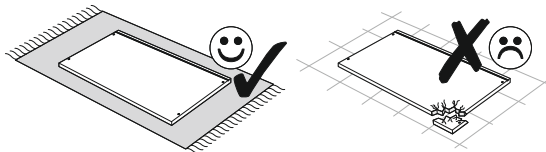

14 ▶

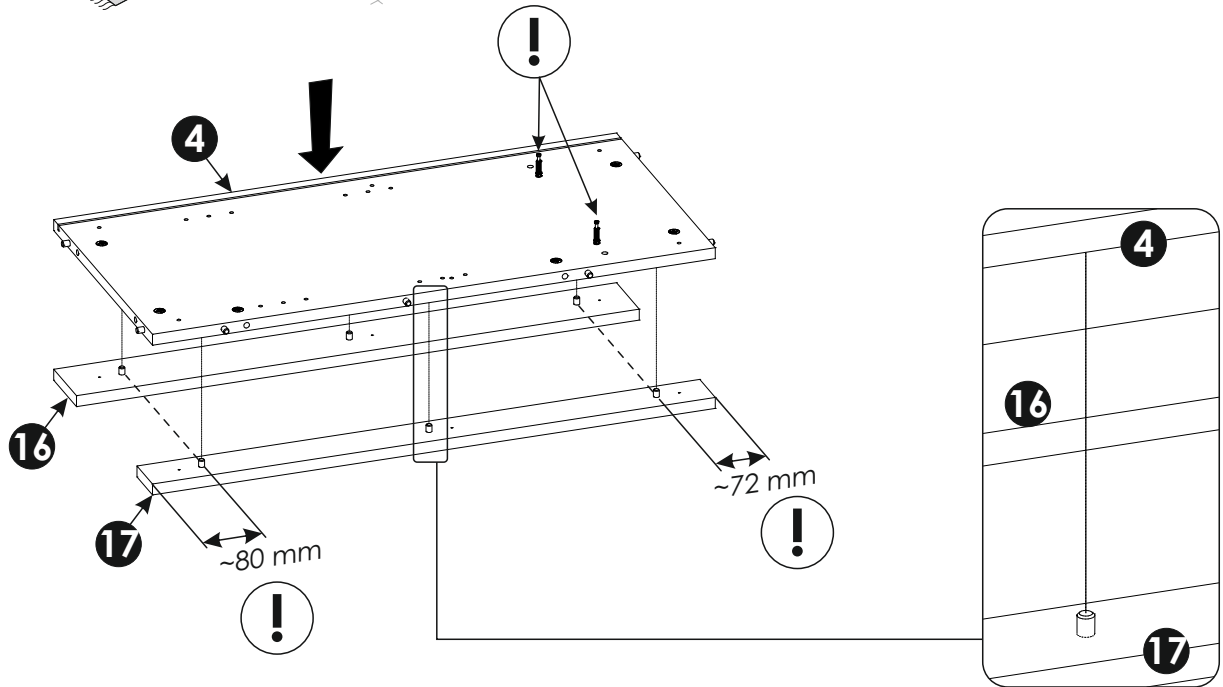
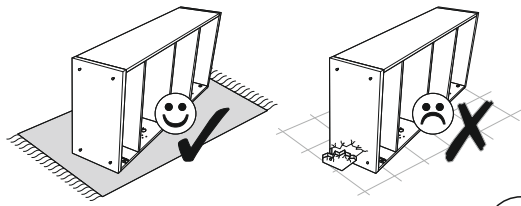

15 ▶

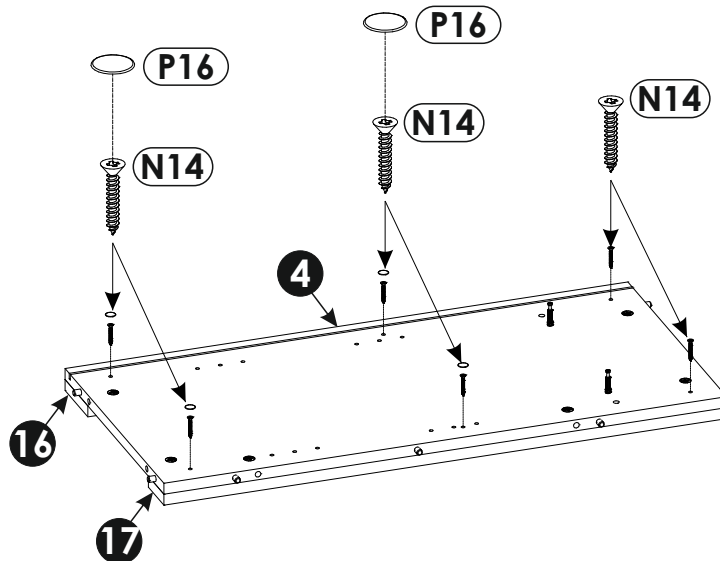
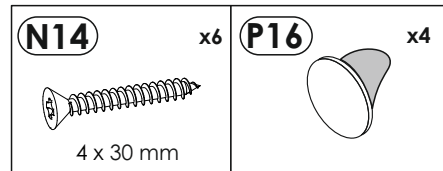
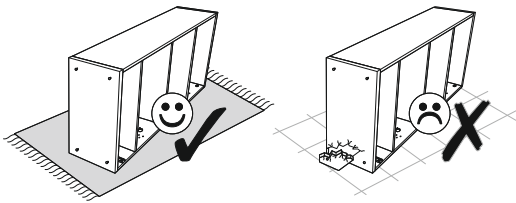

16▶

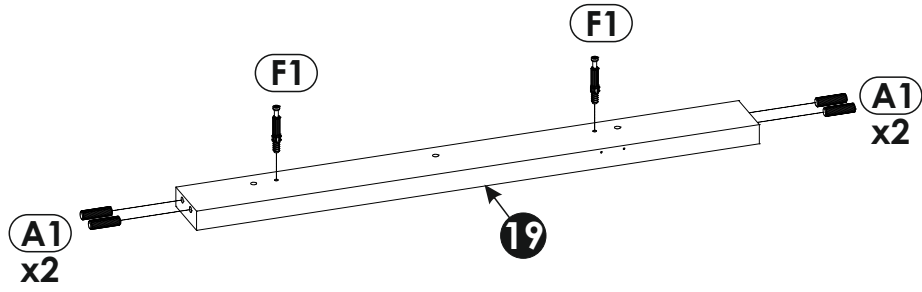
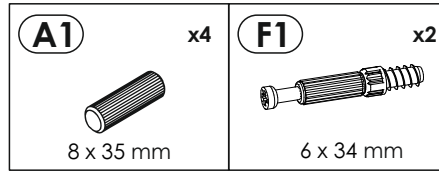
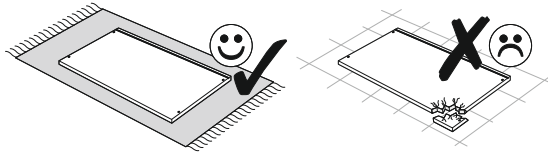

17▶

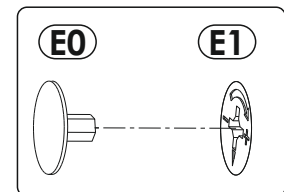
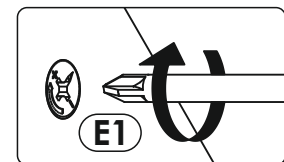
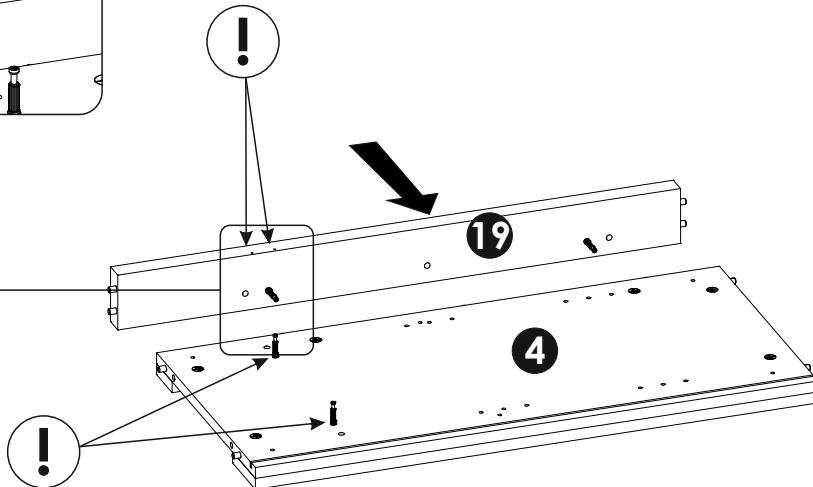
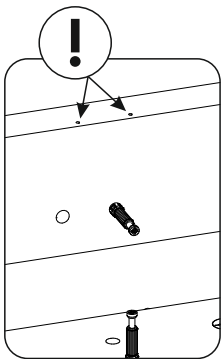
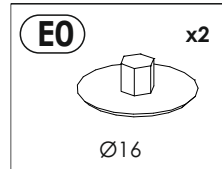
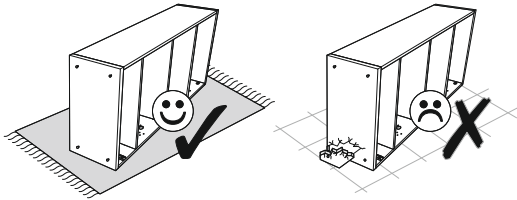

18 ▶

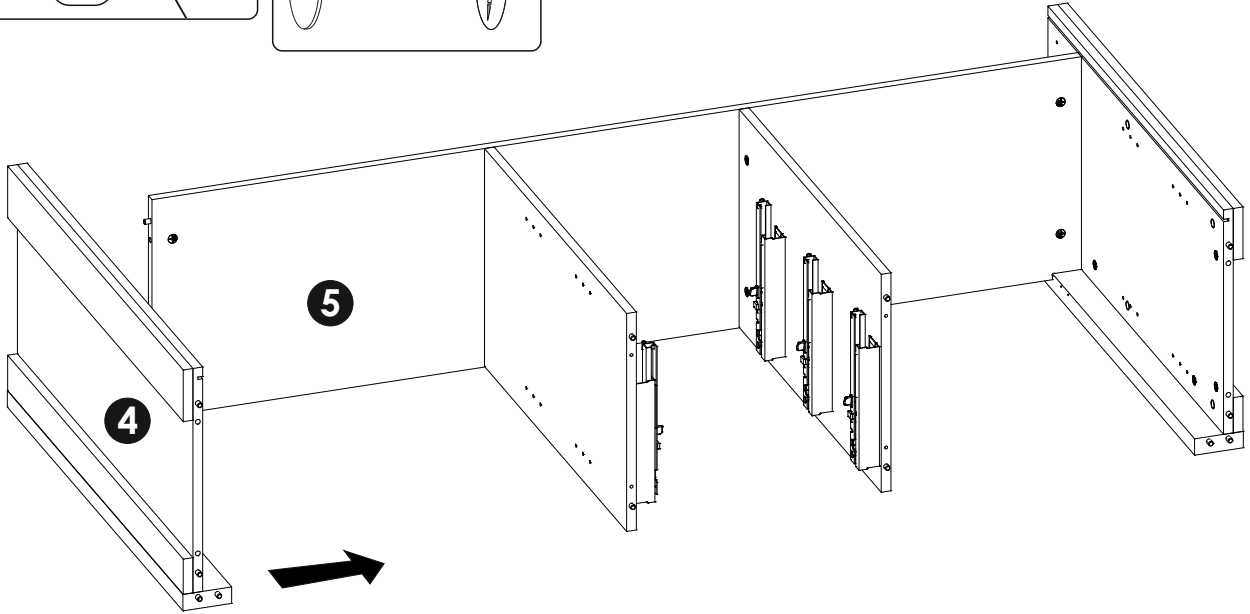
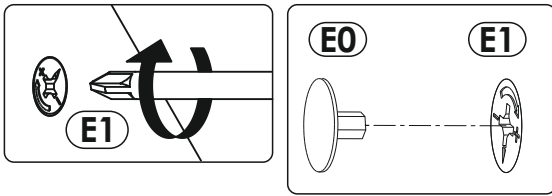
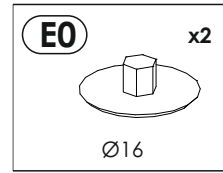
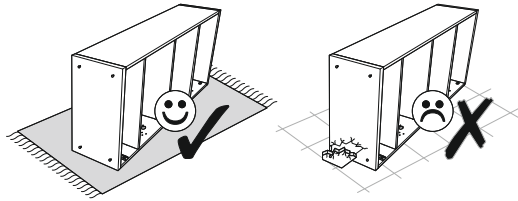

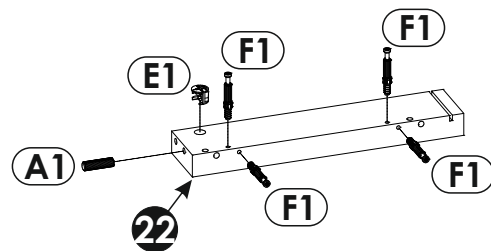
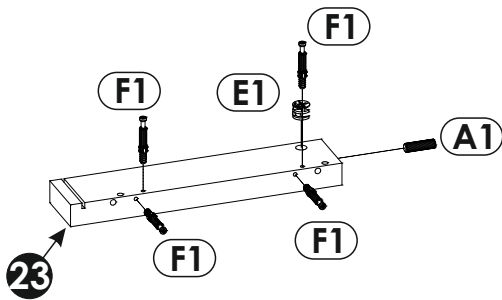
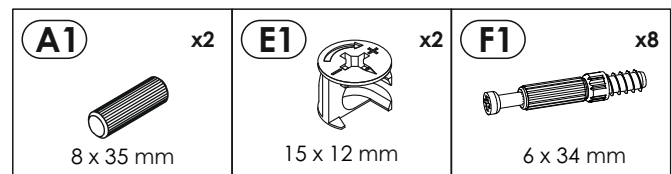
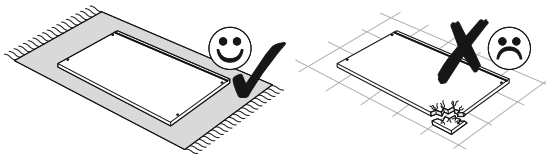

19 ▶

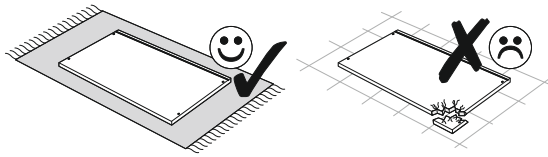

20 ▶

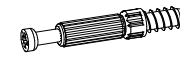

A1 x10  8 x 35 mm	E1 x8  15 x 12 mm	F1 x2  6 x 34 mm
---	--	---

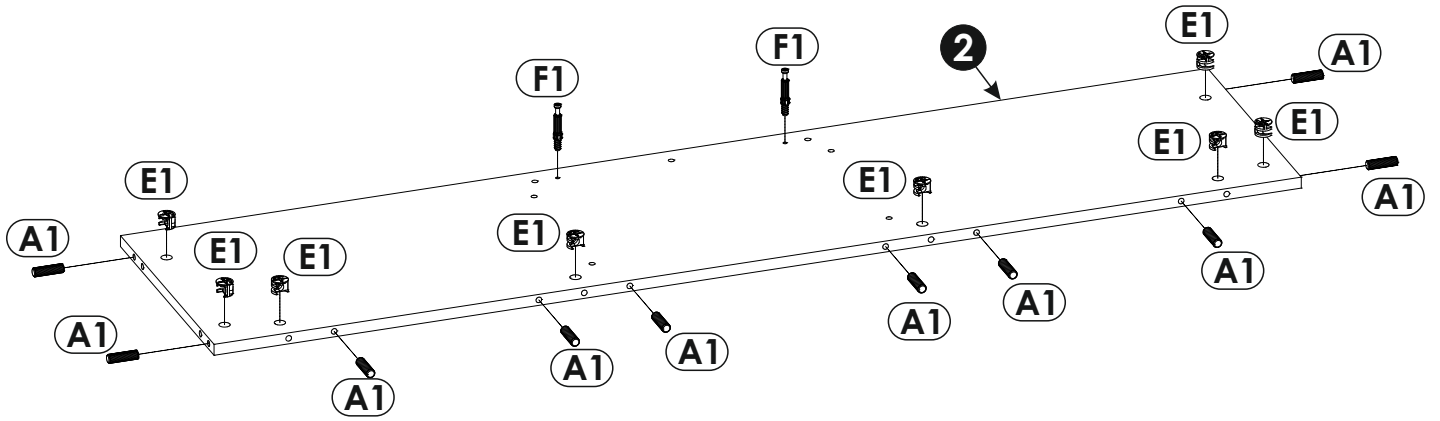

21 ▶

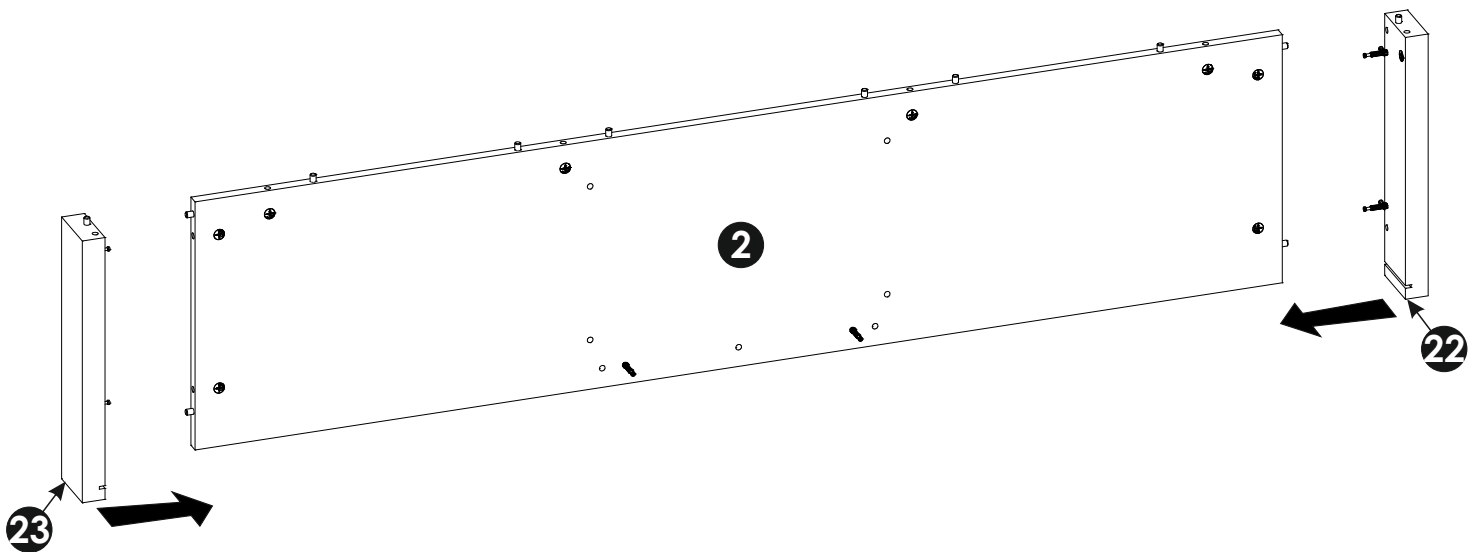
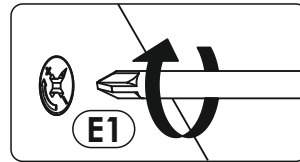
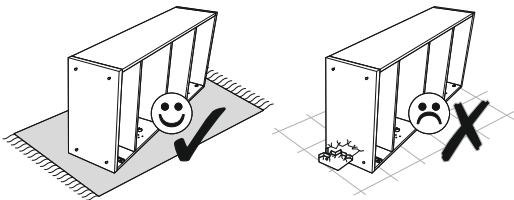

22▶

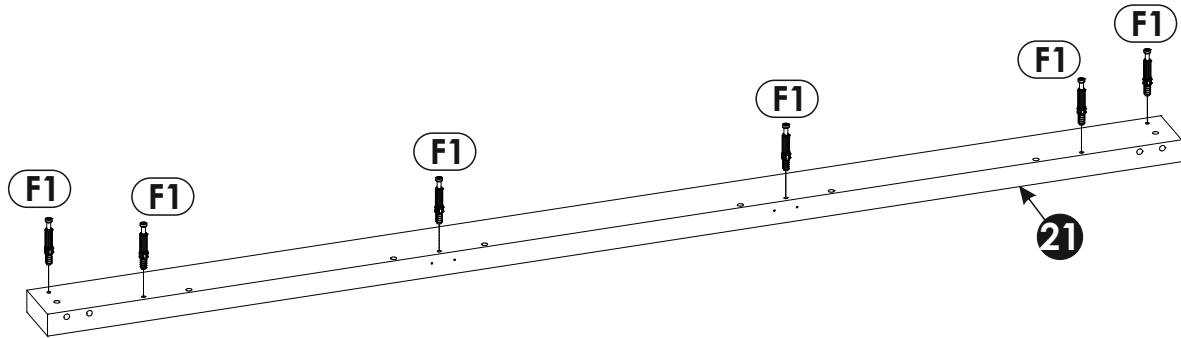
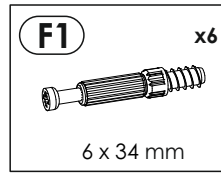
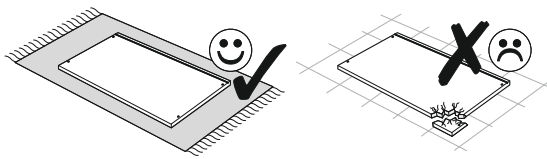

23▶

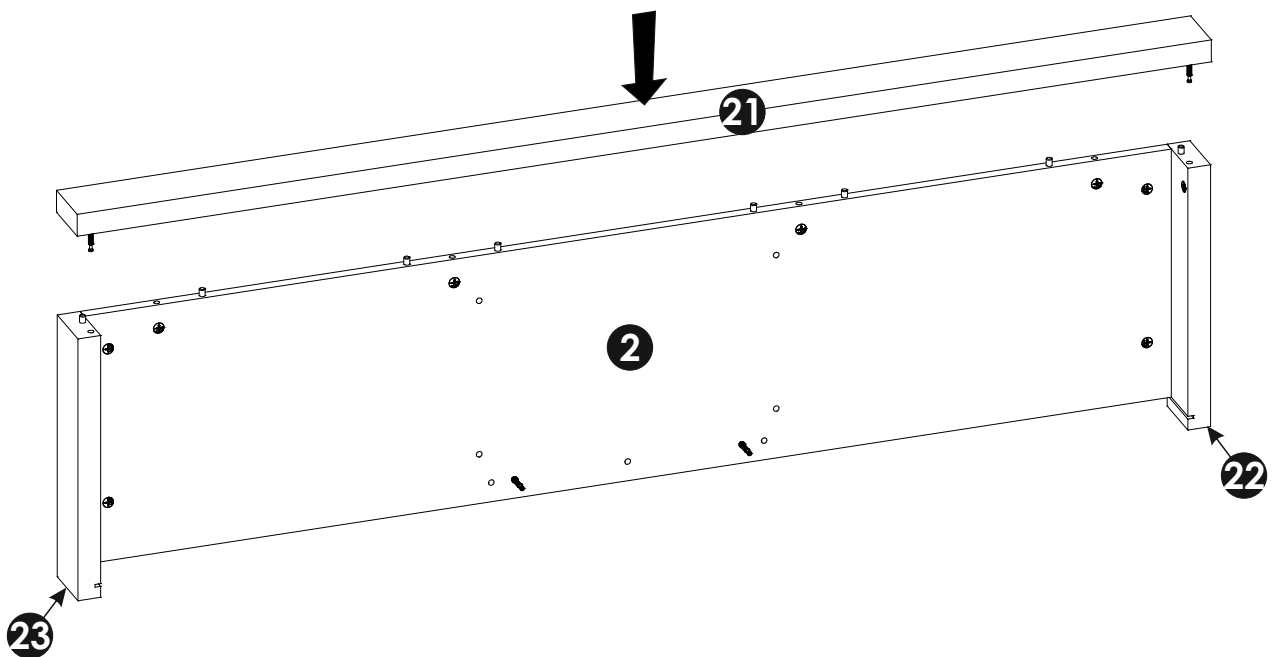
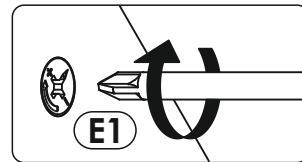
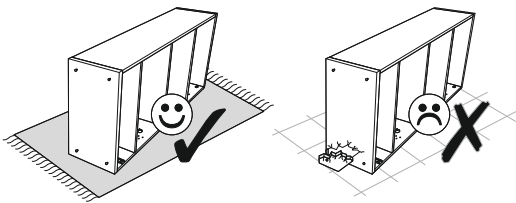

24▶

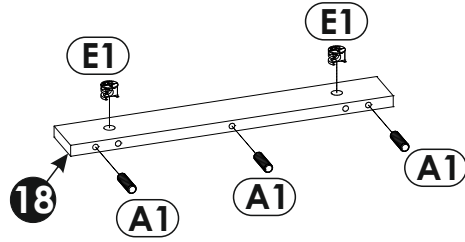
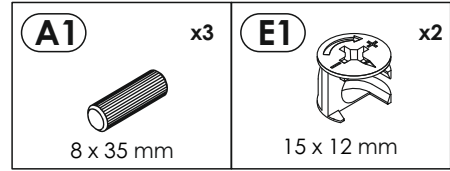
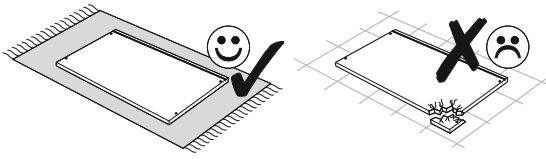

25▶

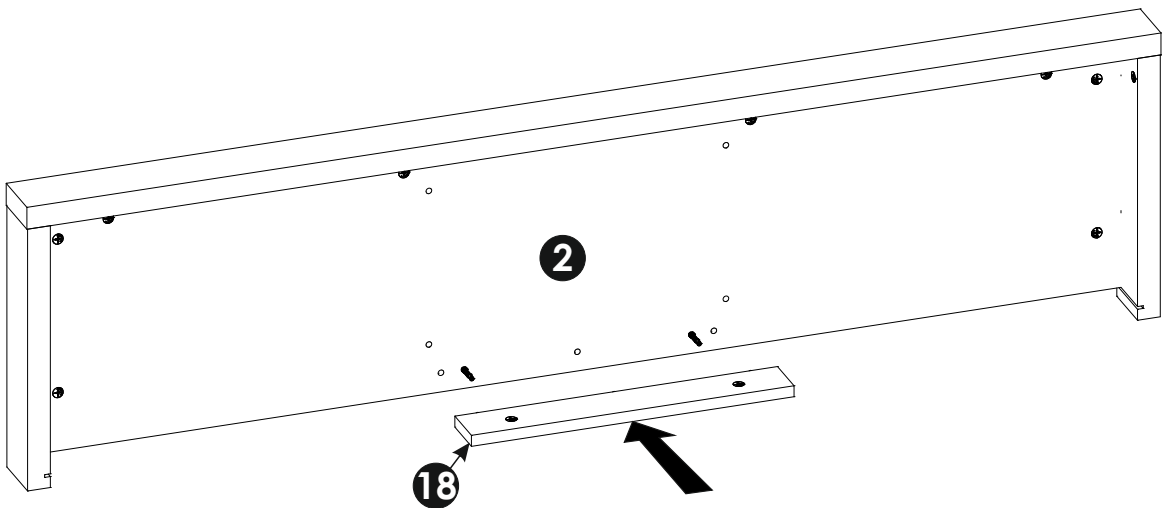
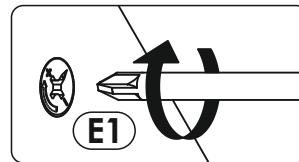
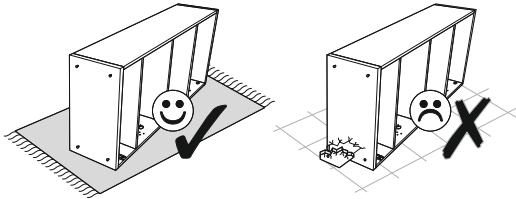

26 ▶

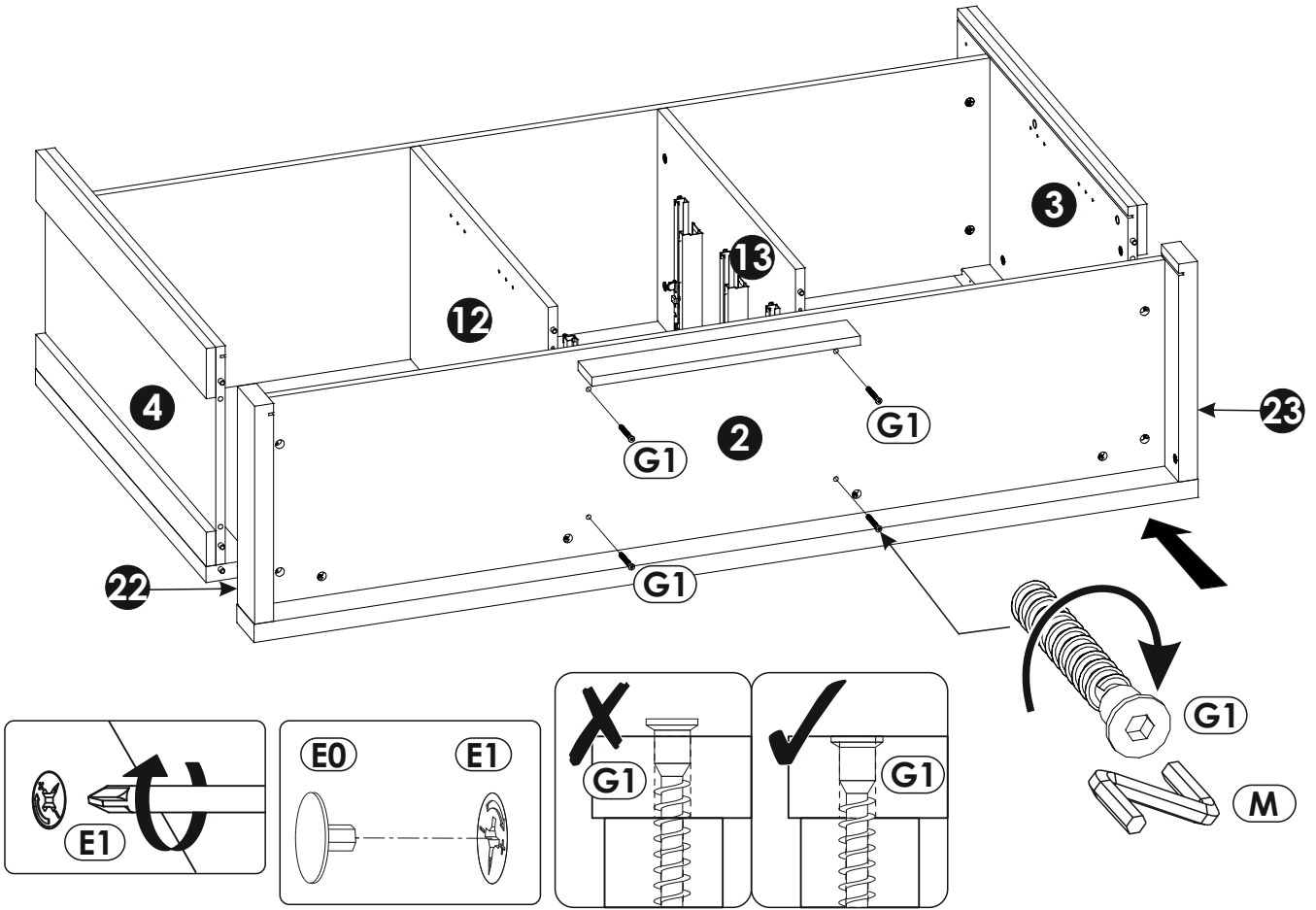
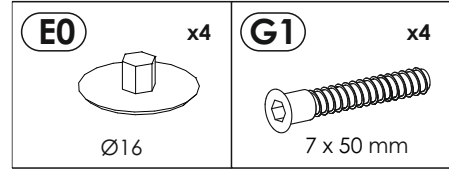
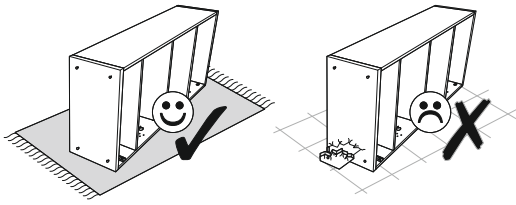

27 ▶

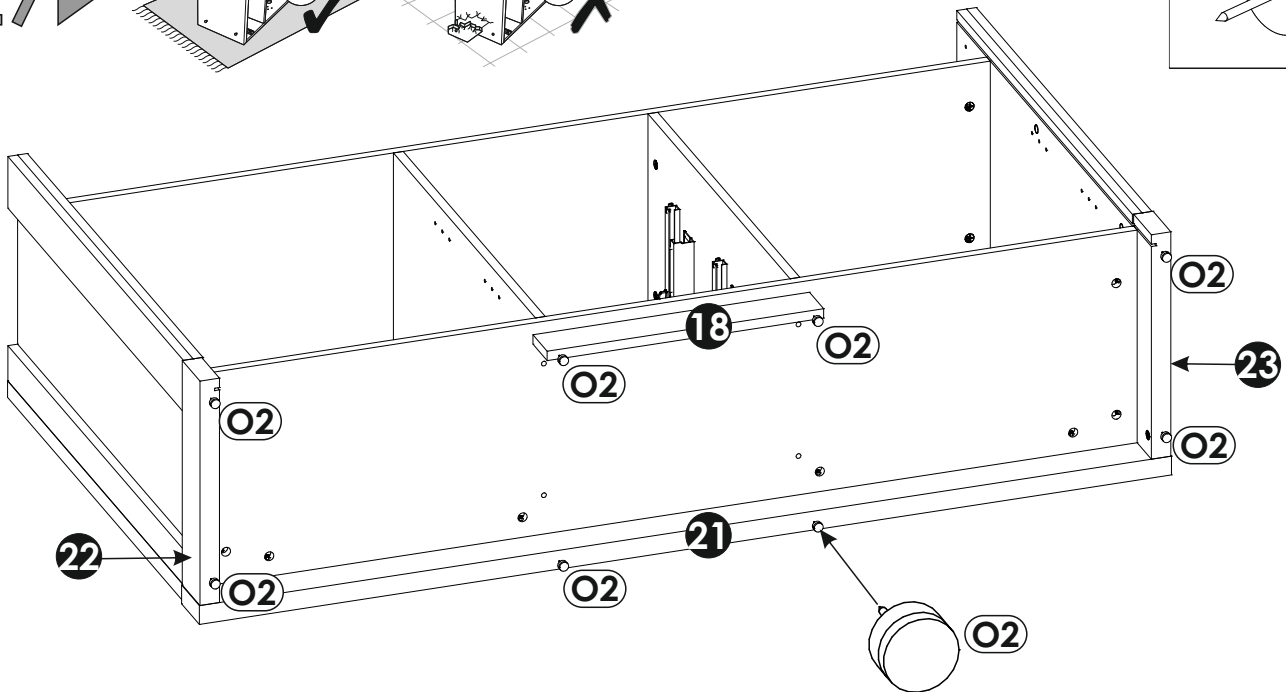
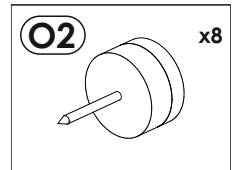
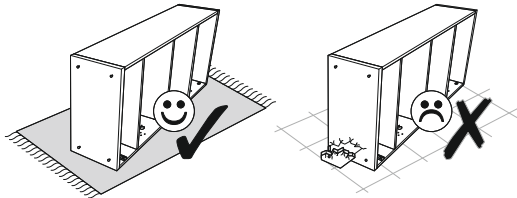

28 ▶

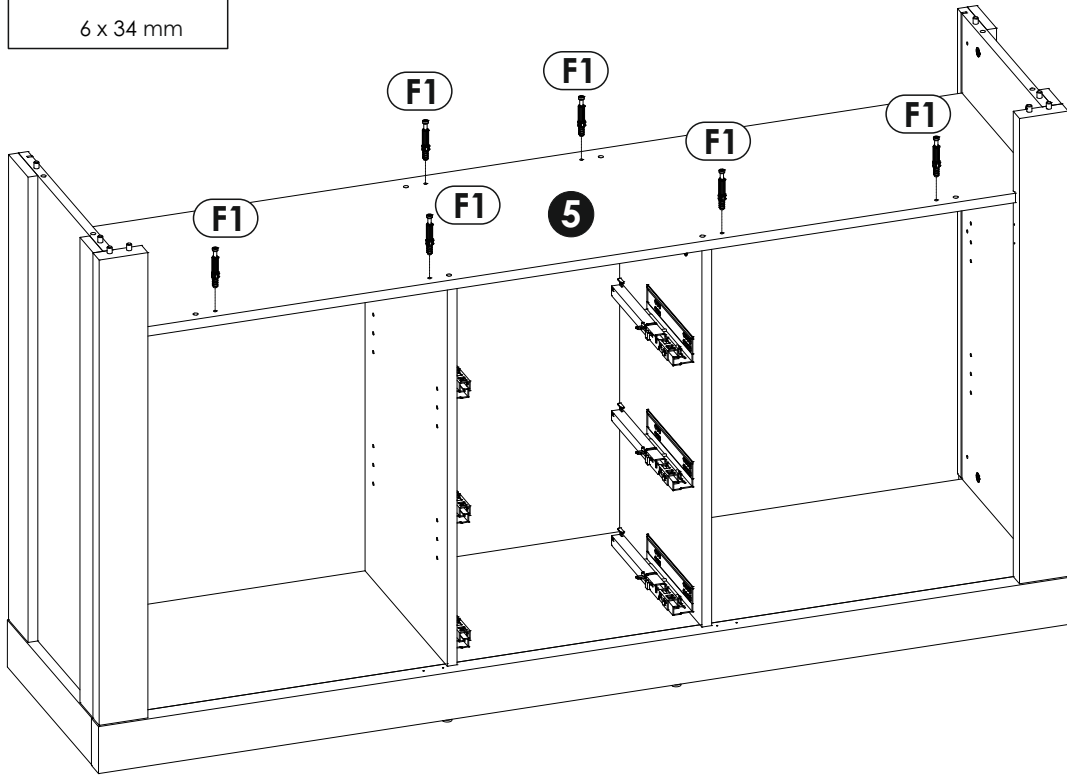
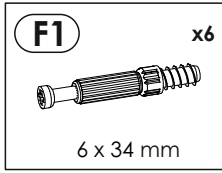

29 ▶

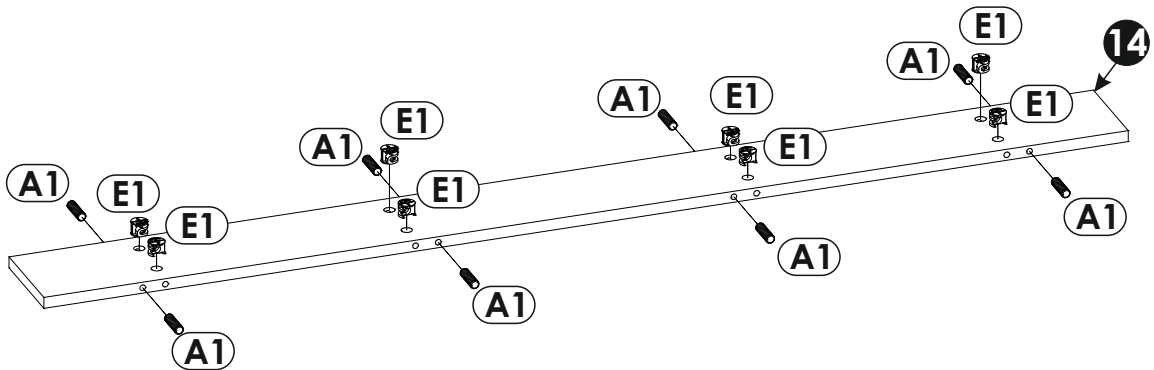
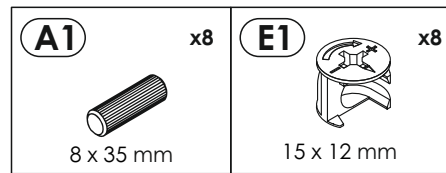
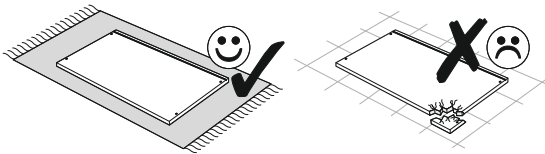

30 ▶

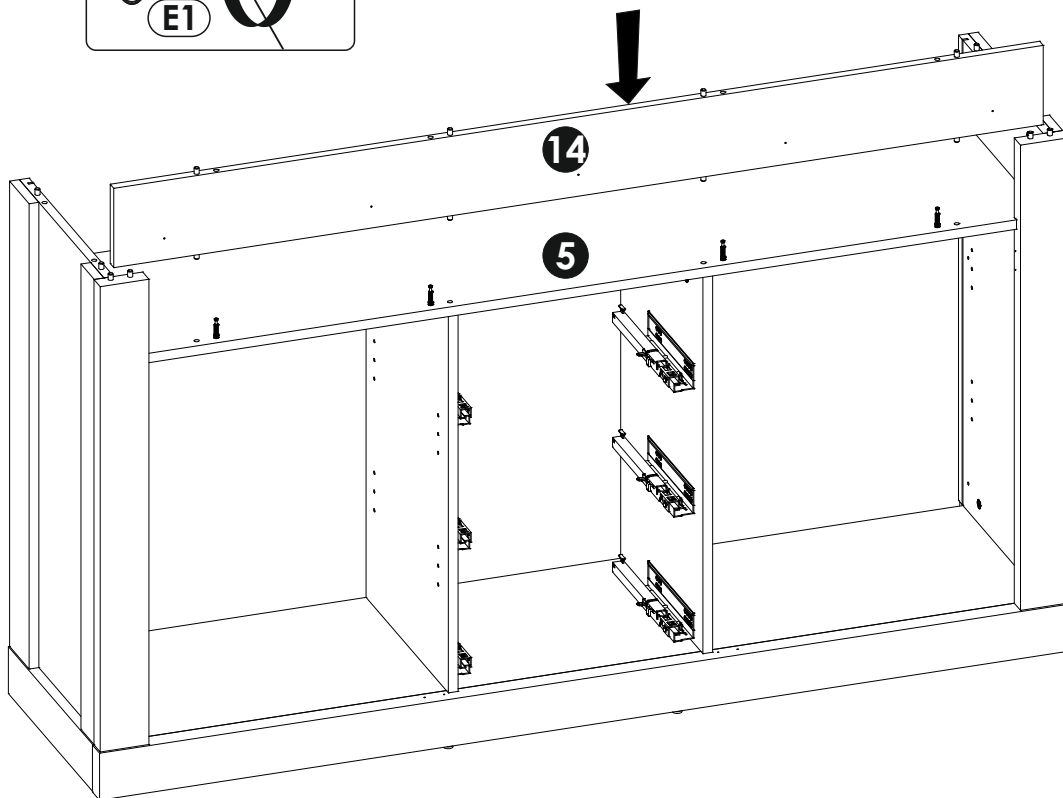
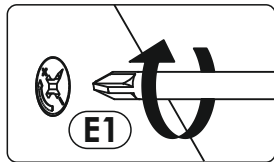

31 ▶

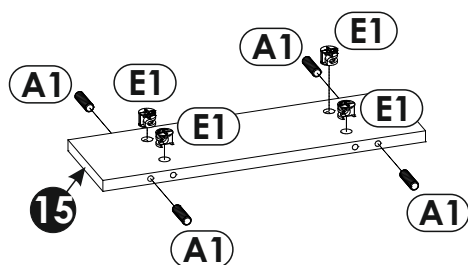
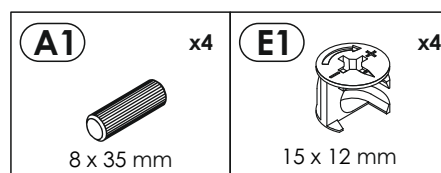
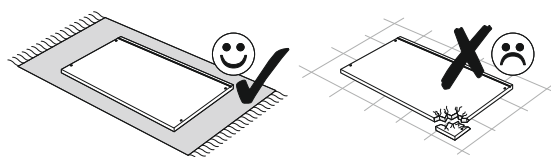

32 ▶

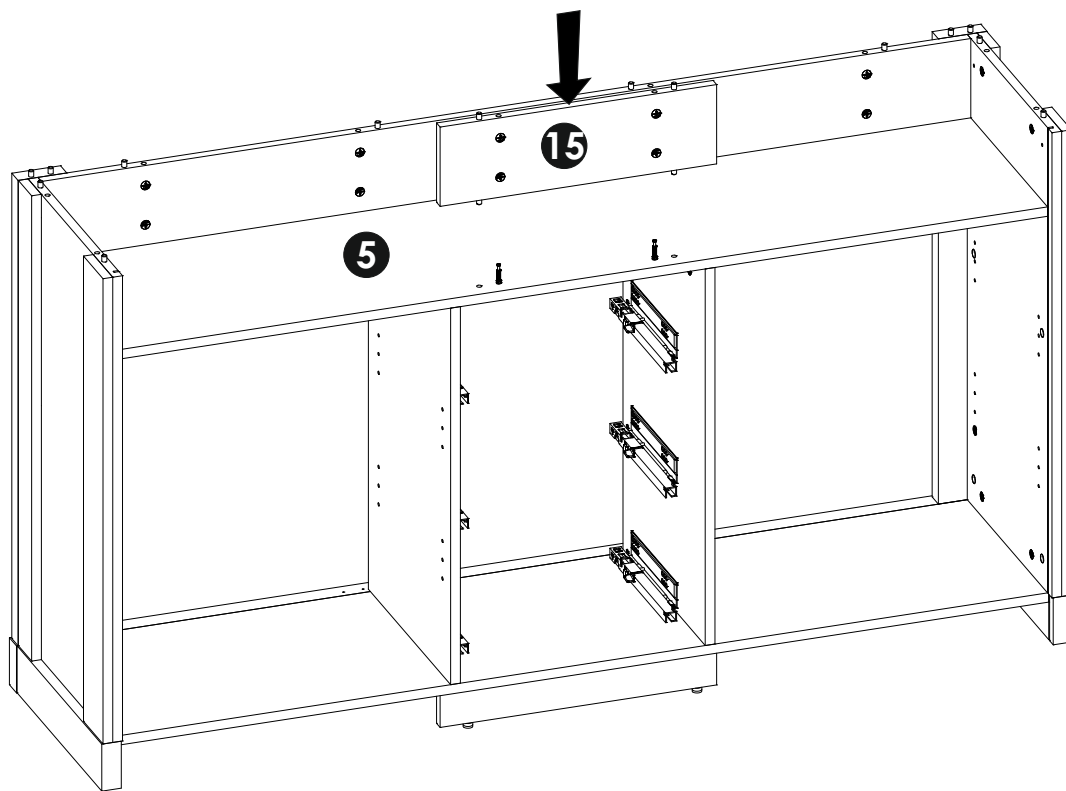
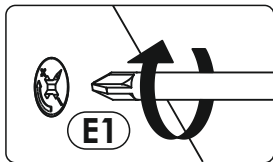

33 ▶

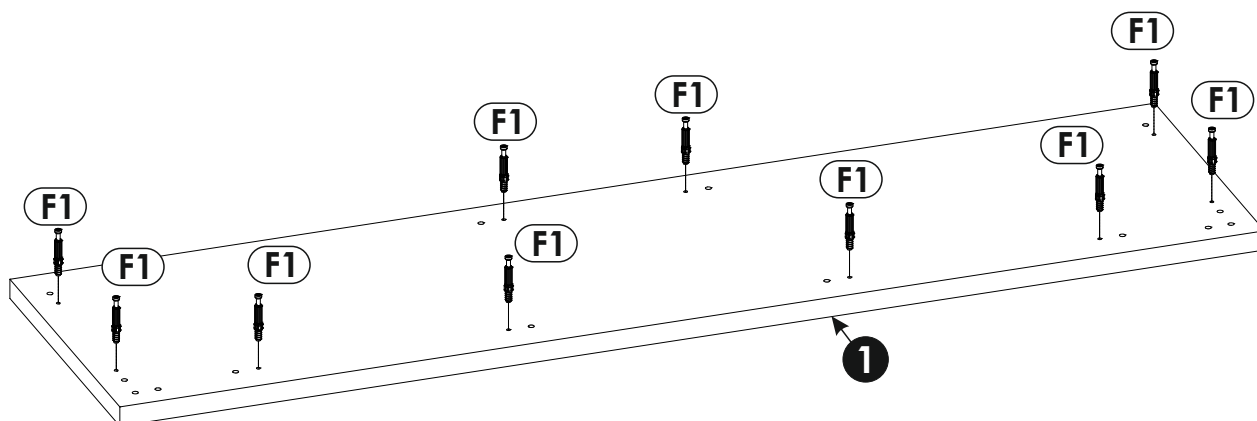
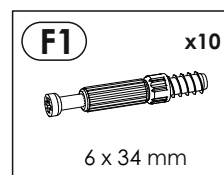
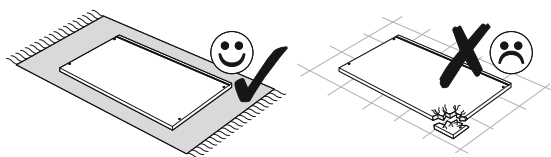

34 ▶

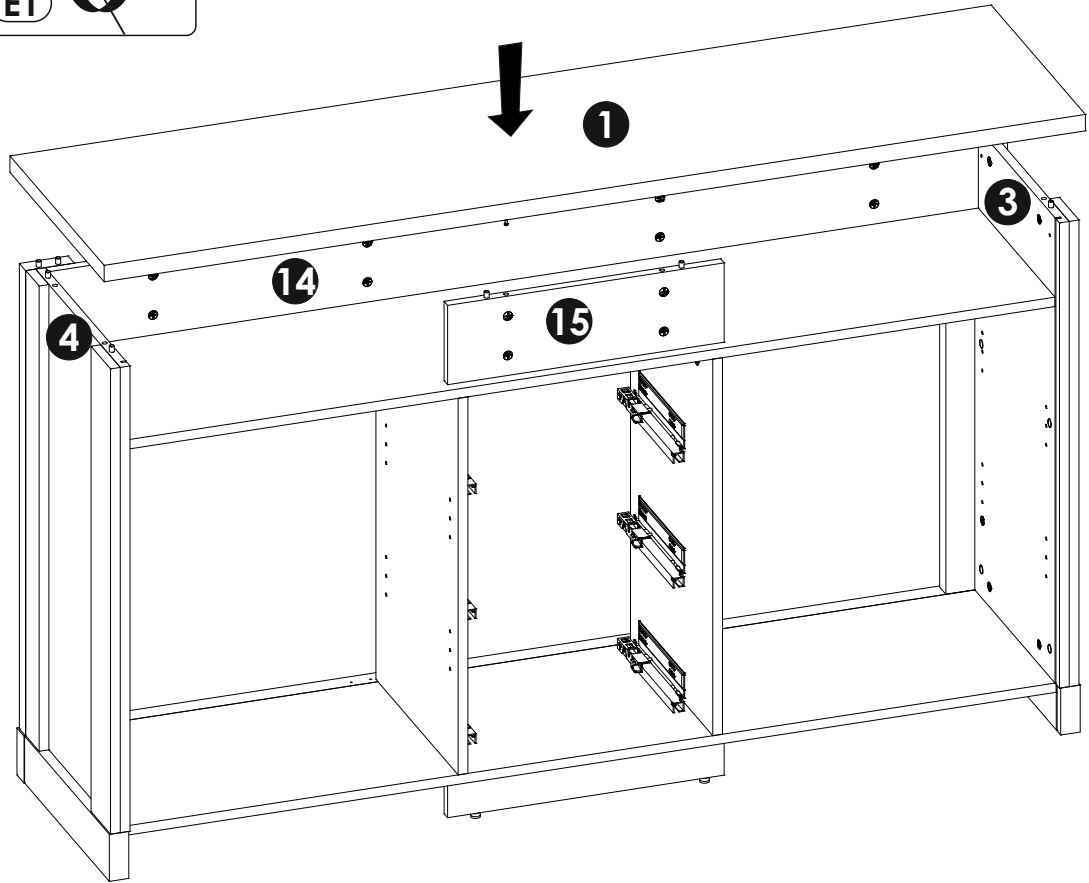
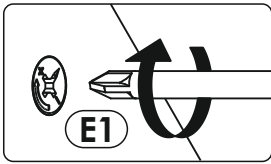

35 ▶

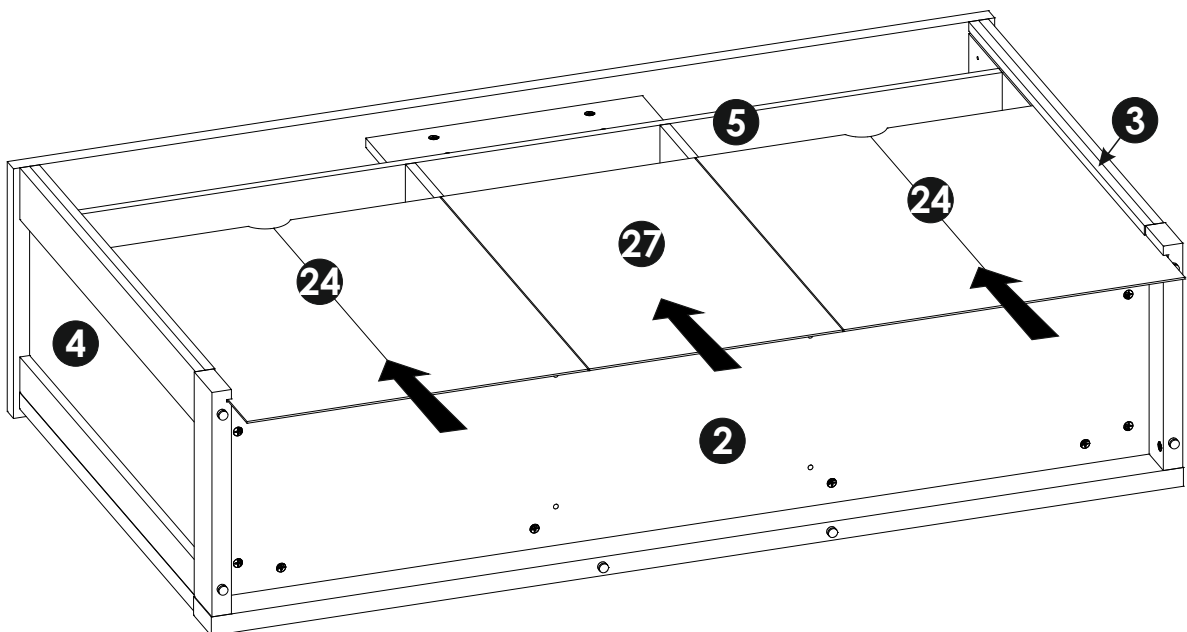
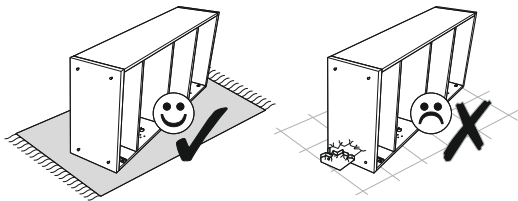

36 ▶

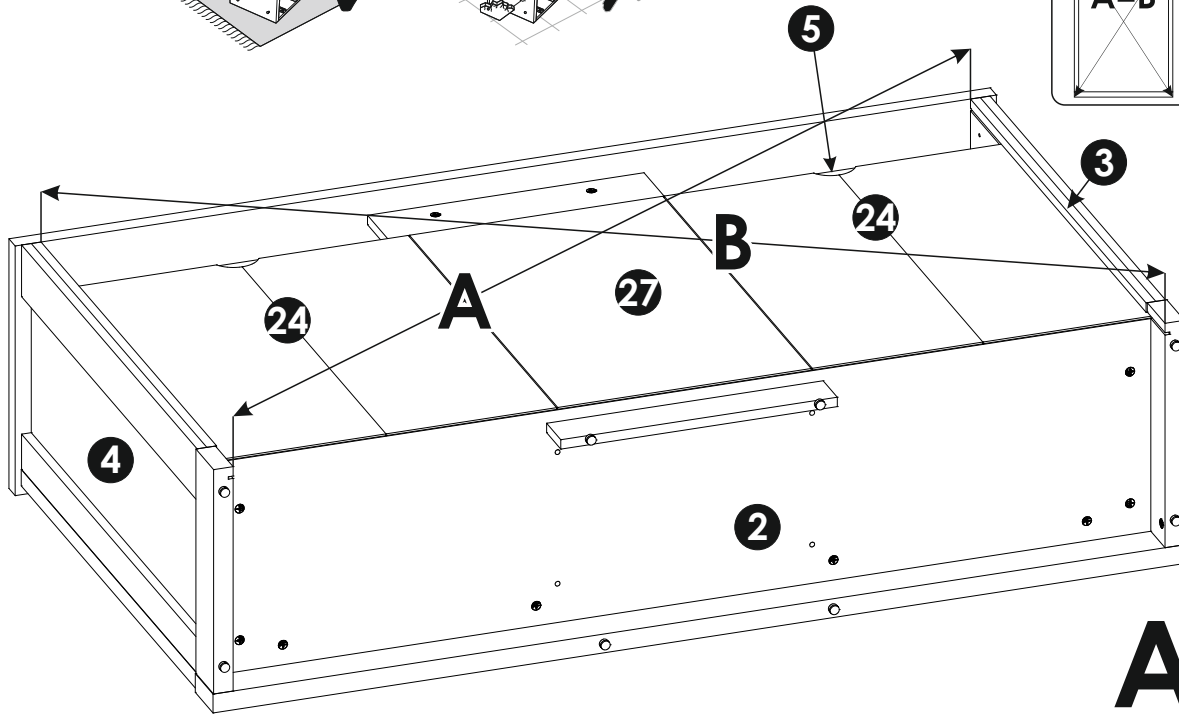
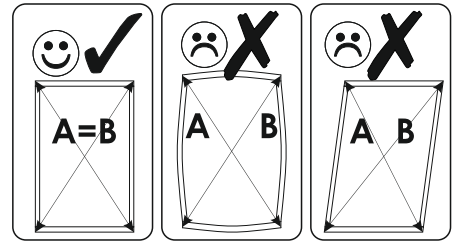
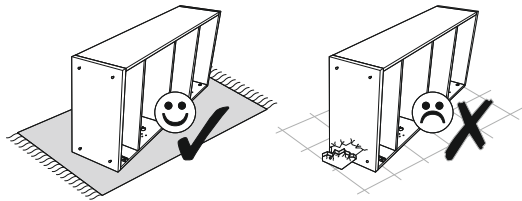

A=B

37 ▶

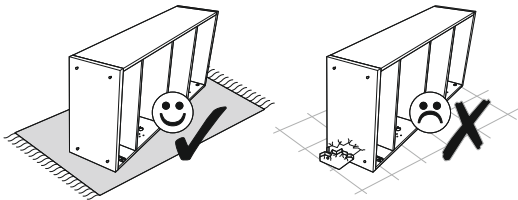

N1	x30	R1	x8	R4	x4
3 X 16 mm					

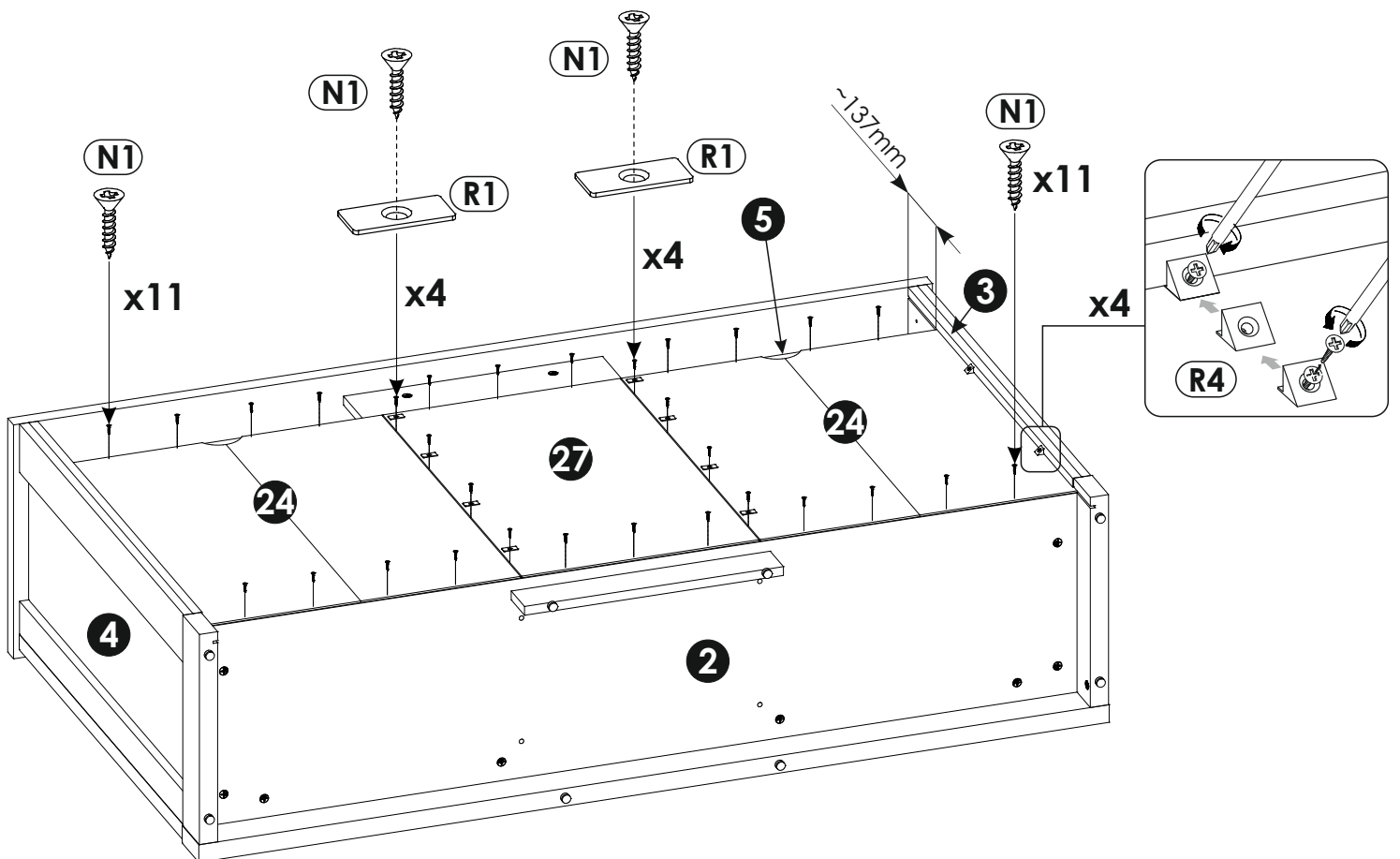

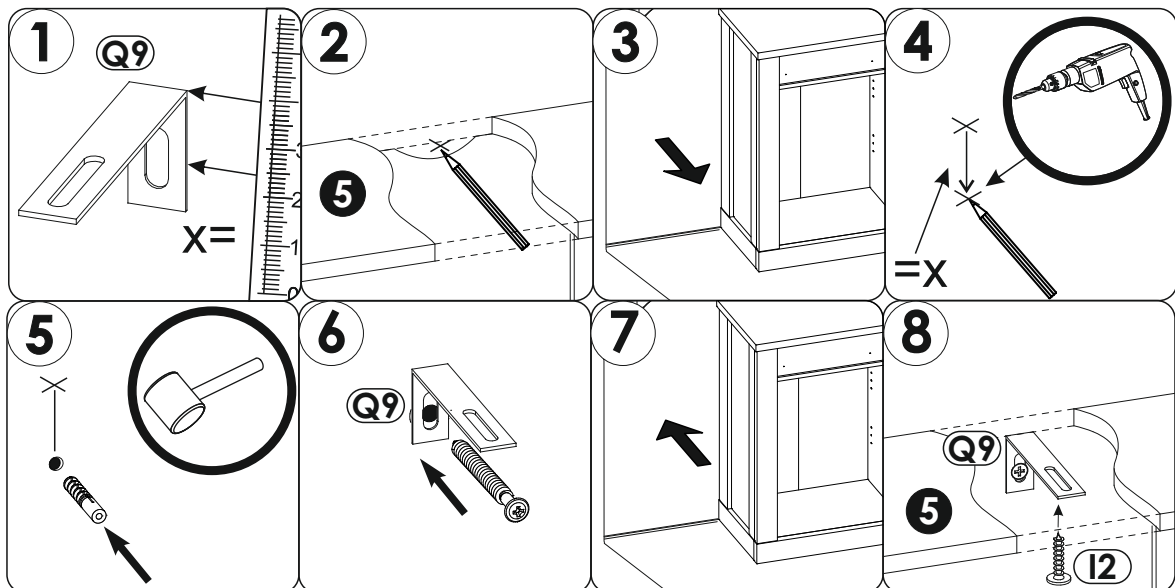
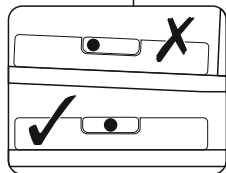
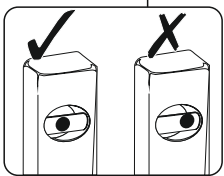
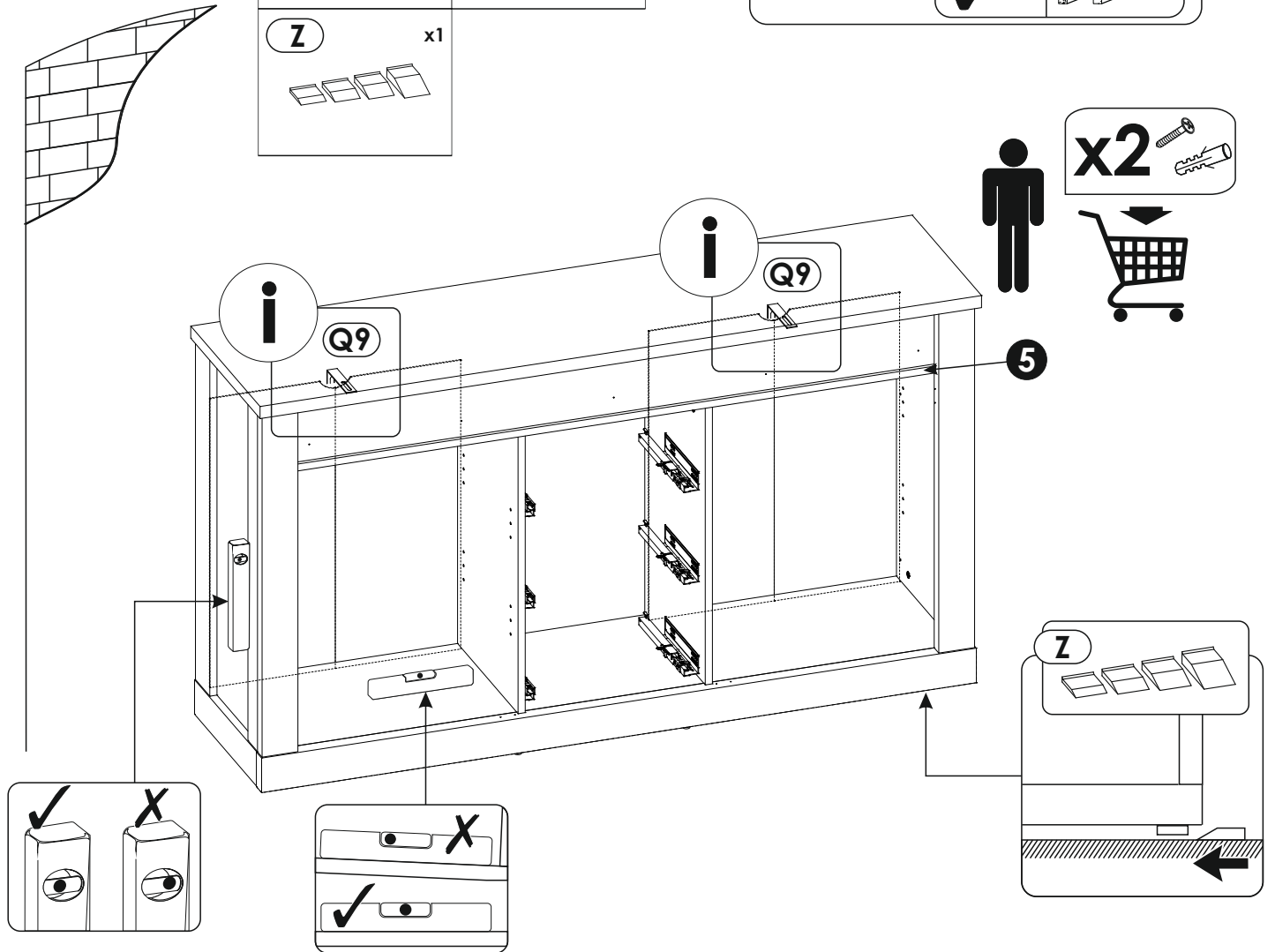
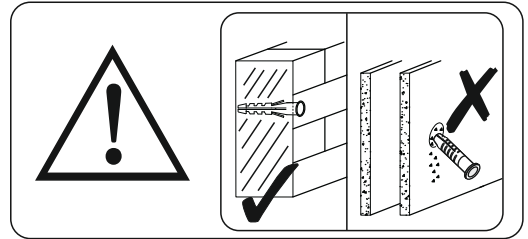
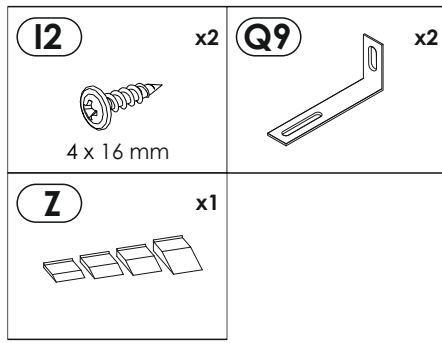

39▶

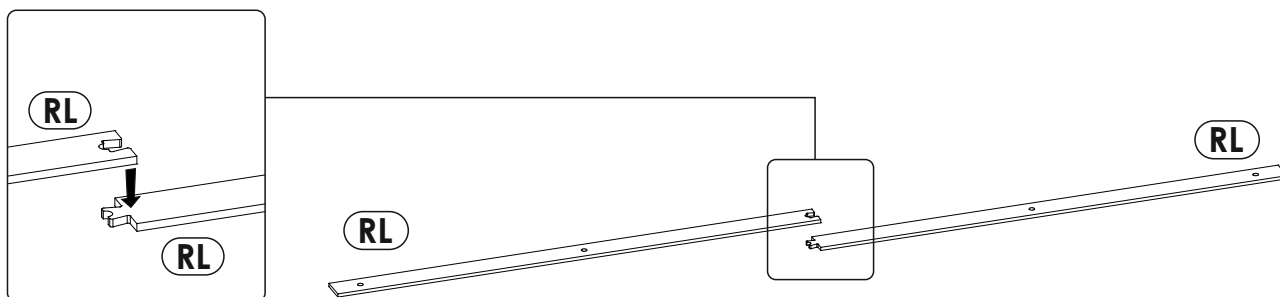
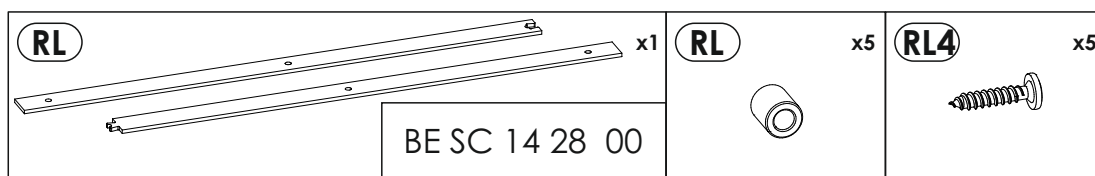





a.

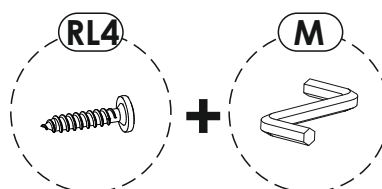
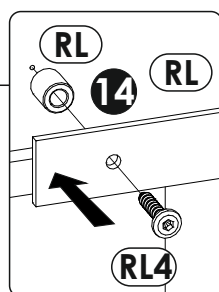
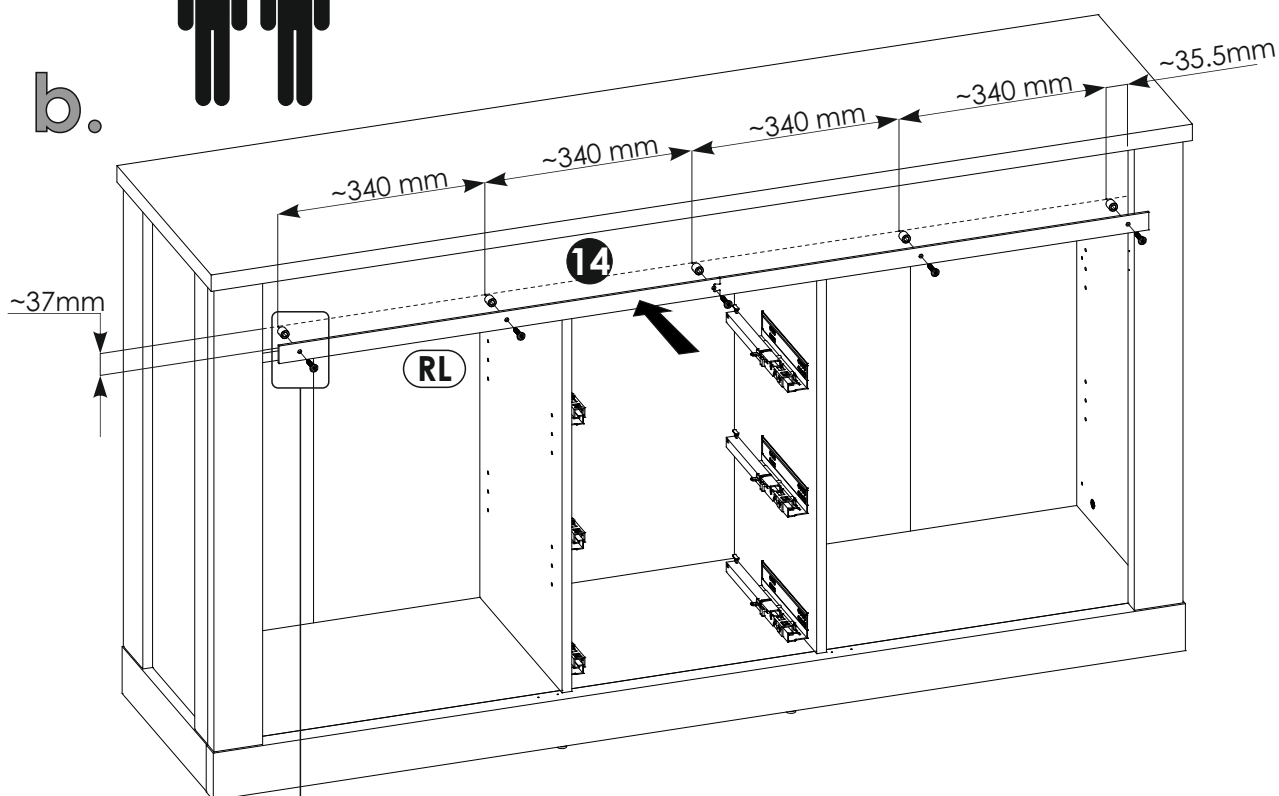

b.

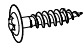

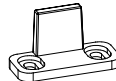
40 ▶

I0	x4	R10	x2	RL	x2	RL2	x4
							
3 x 13 mm							

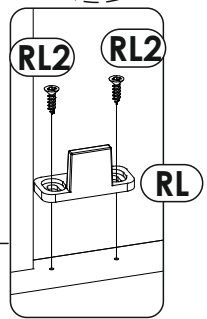
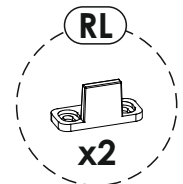
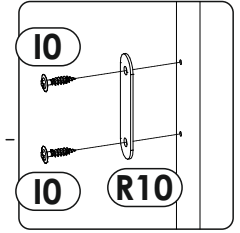
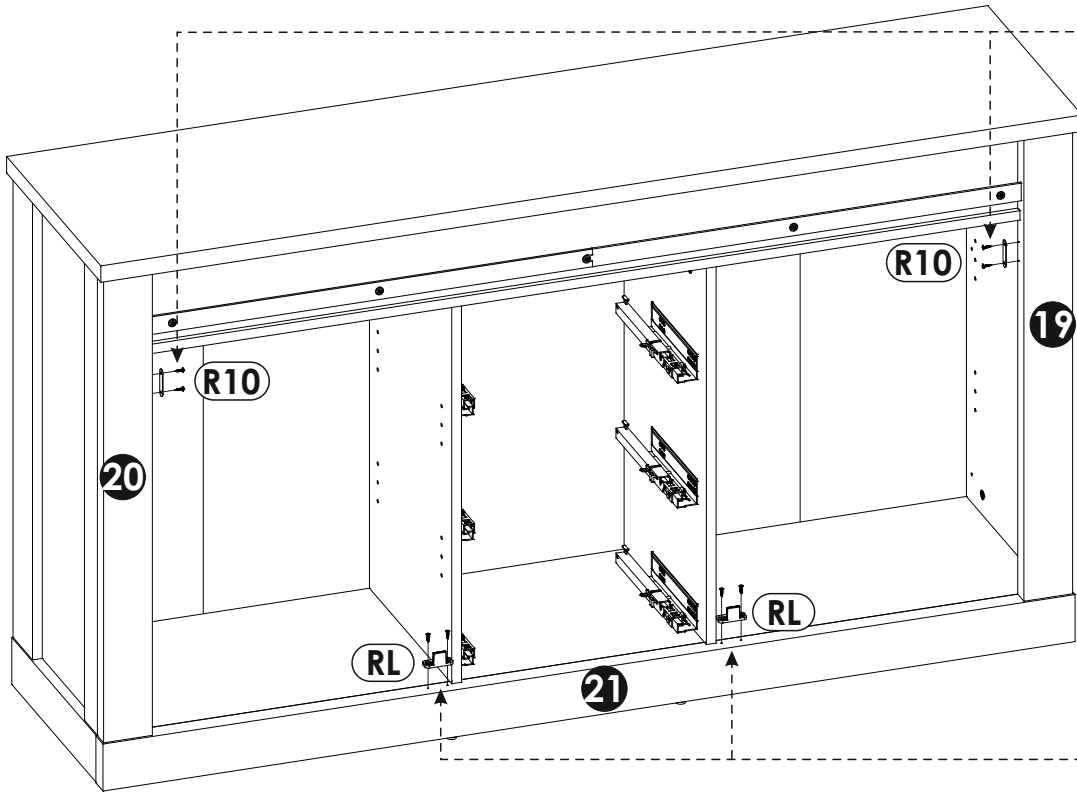

41 ▶

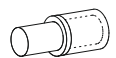
D2	x16
	

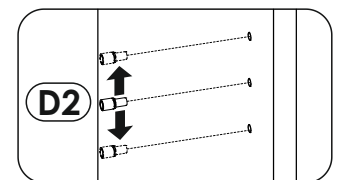
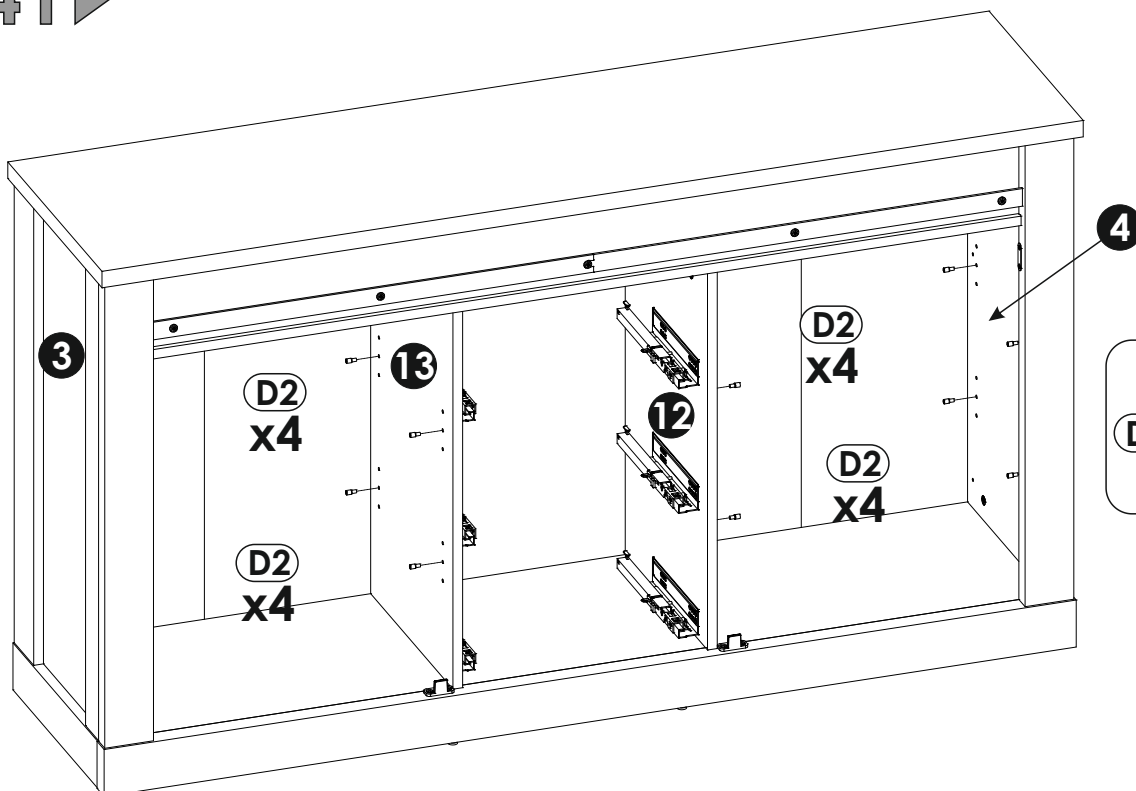

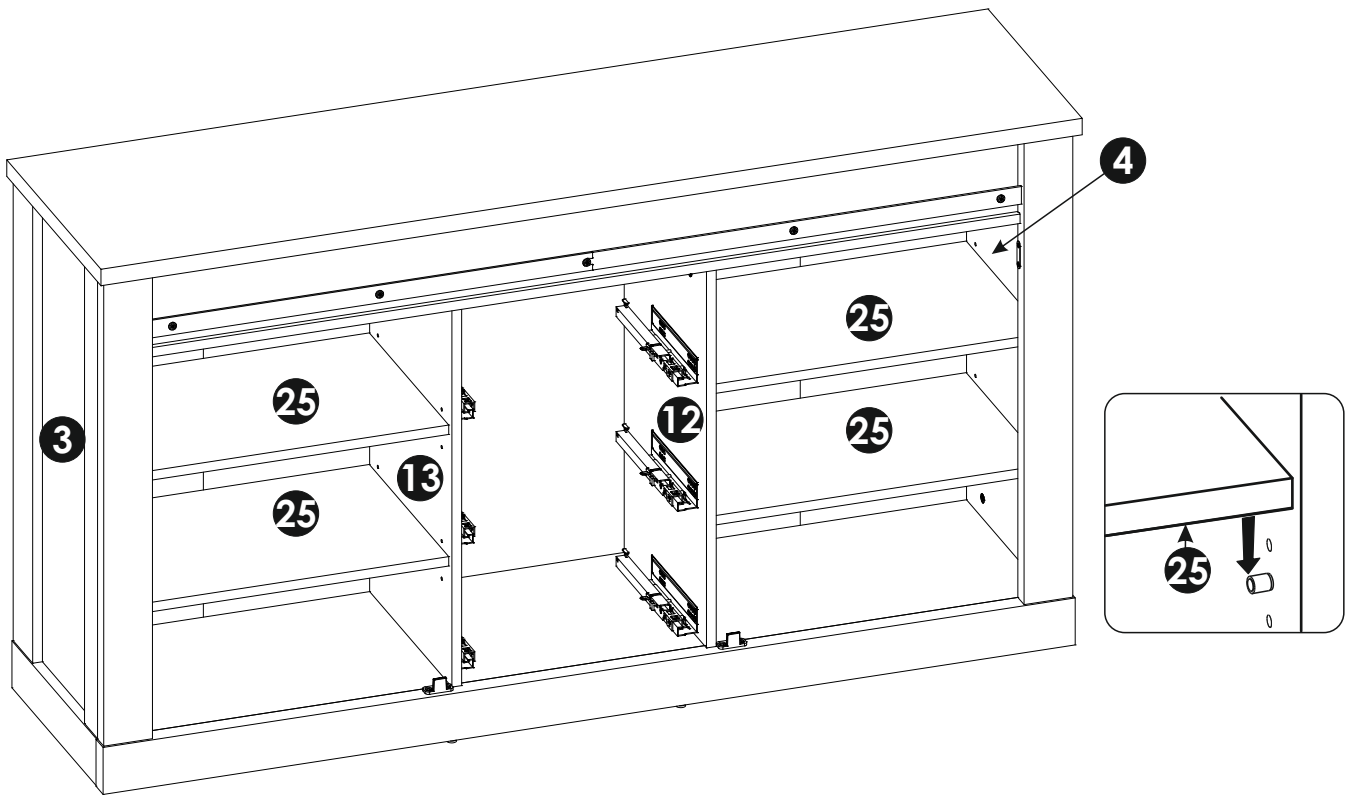

42▶

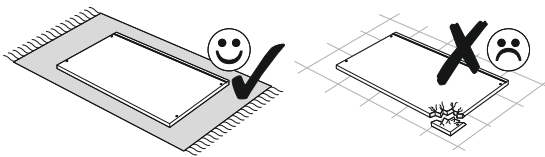

43▶

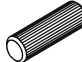

A1	x12	E1	x6
			
8 x 35 mm		15 x 12 mm	

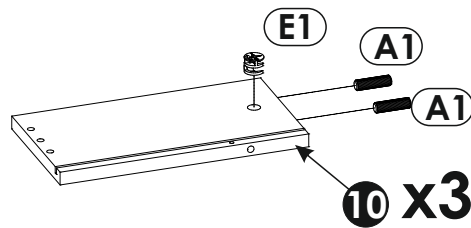
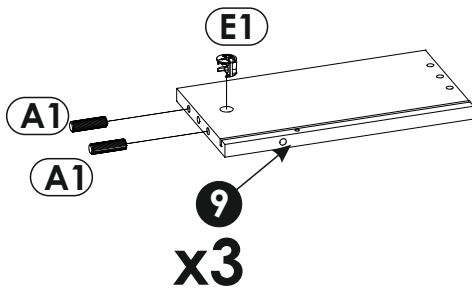

44▶

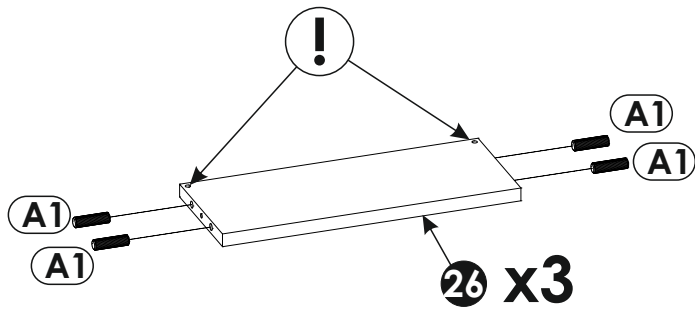
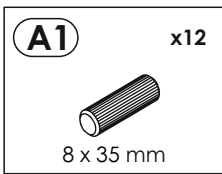
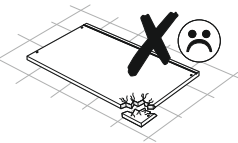
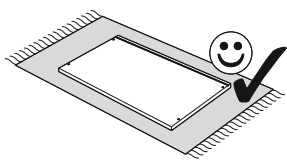

45▶

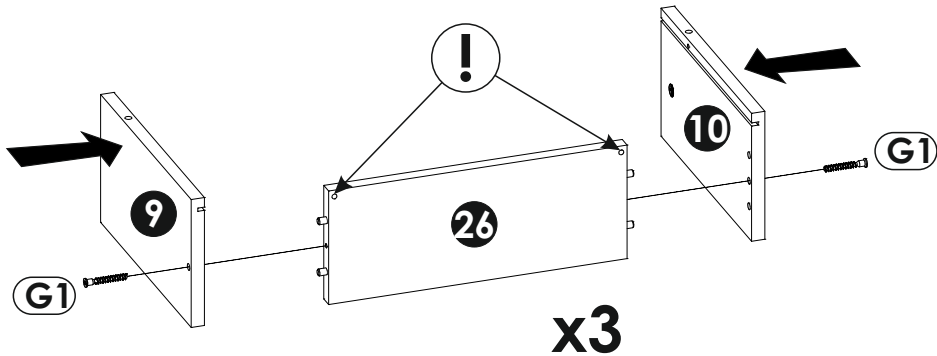
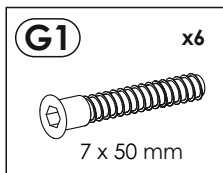
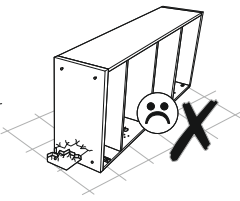
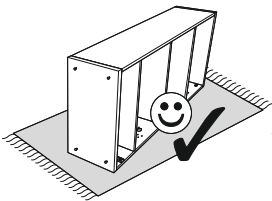

46▶

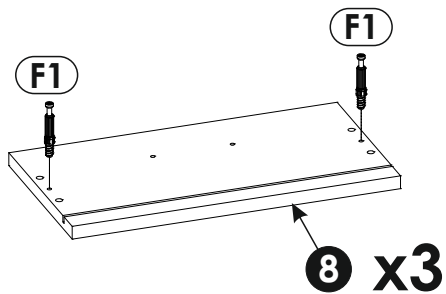
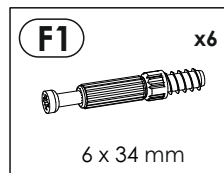
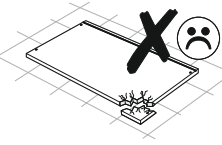
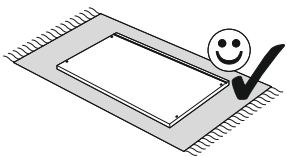

47▶

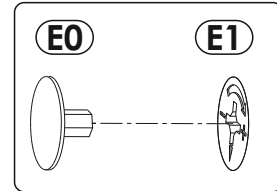
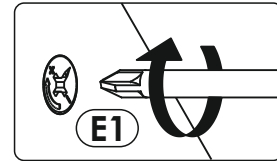
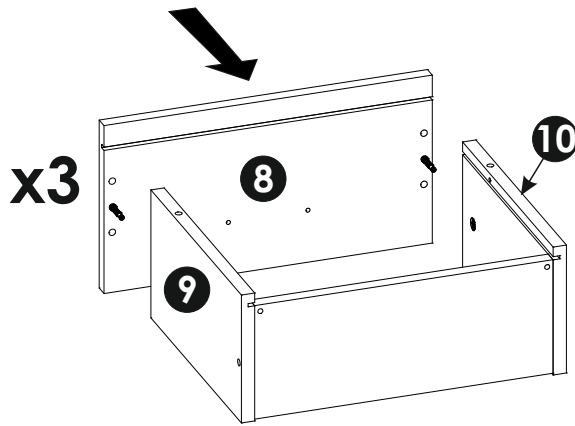
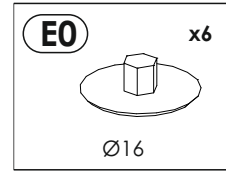
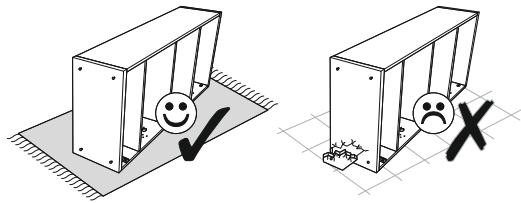

48▶

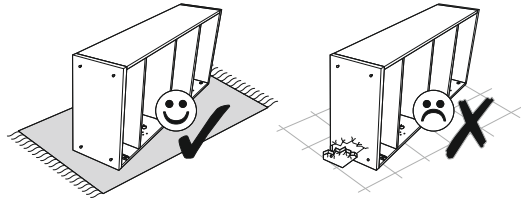

x3

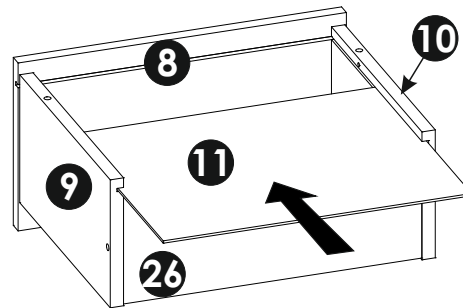

49▶

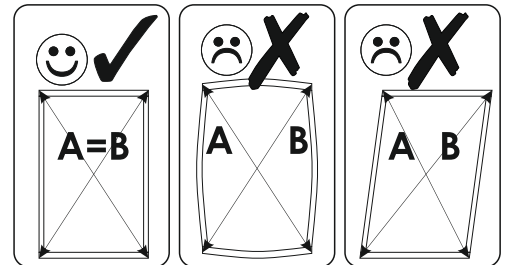
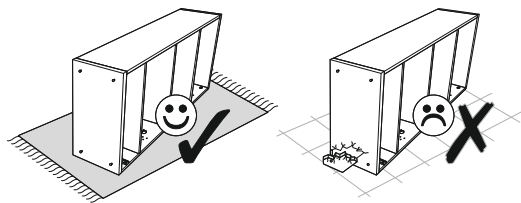

x3

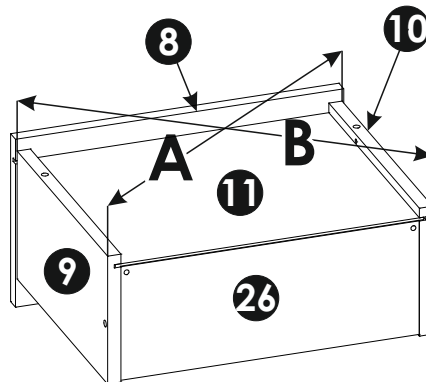

A=B

50▶

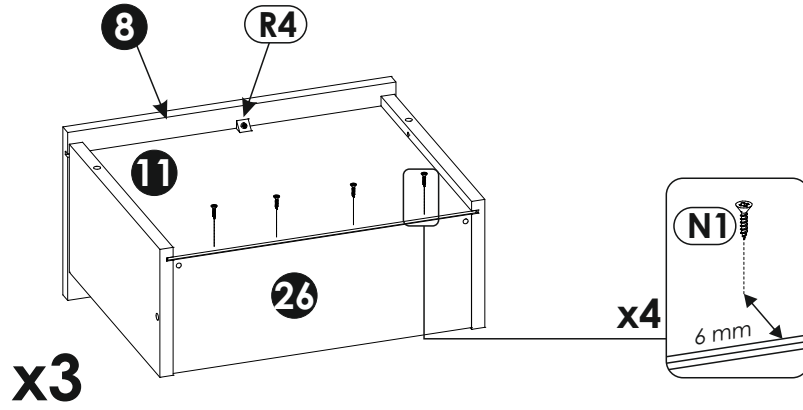
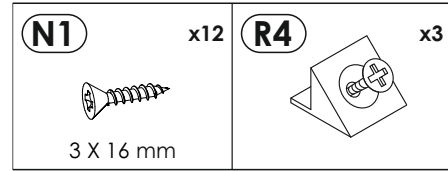
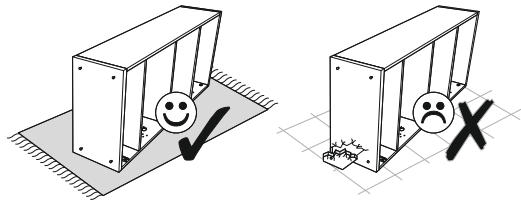

51▶

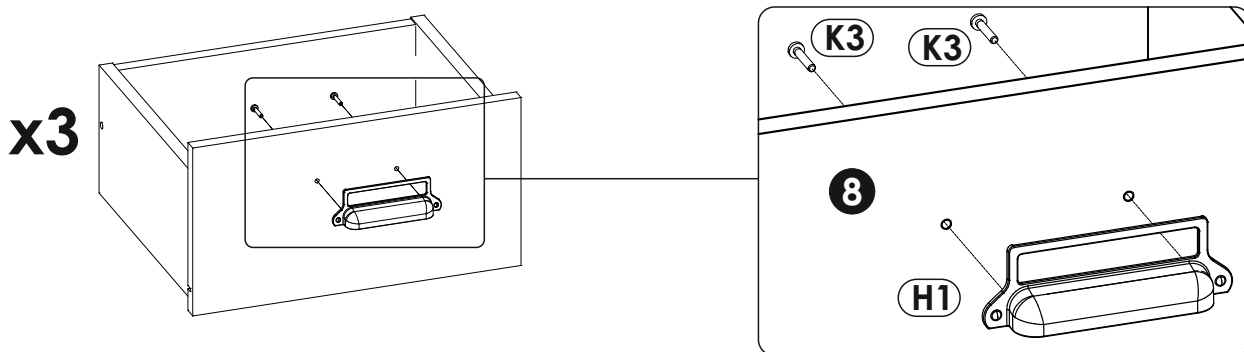
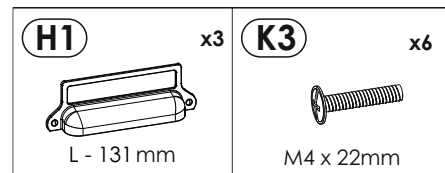
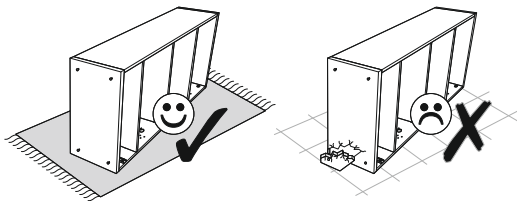

52▶

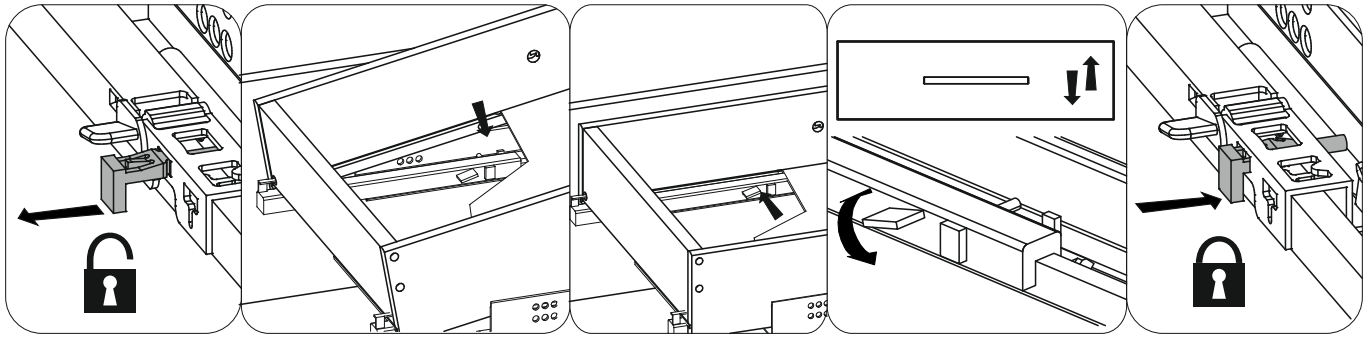
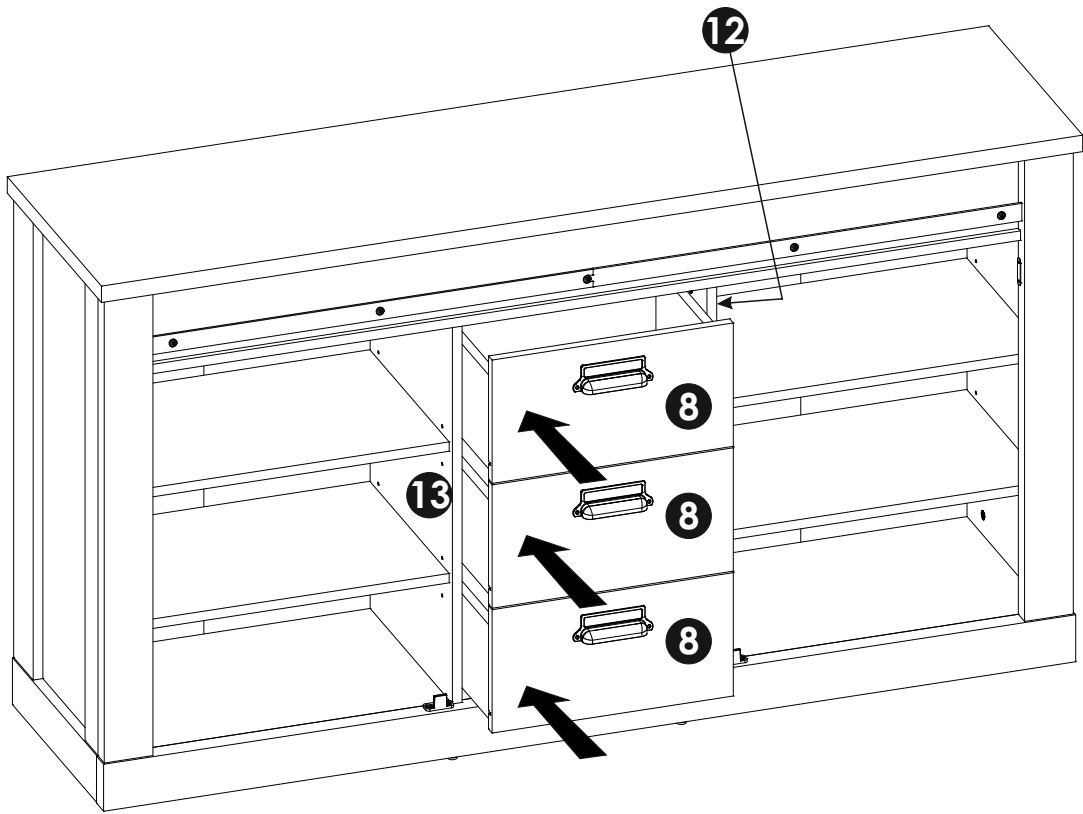

53▶

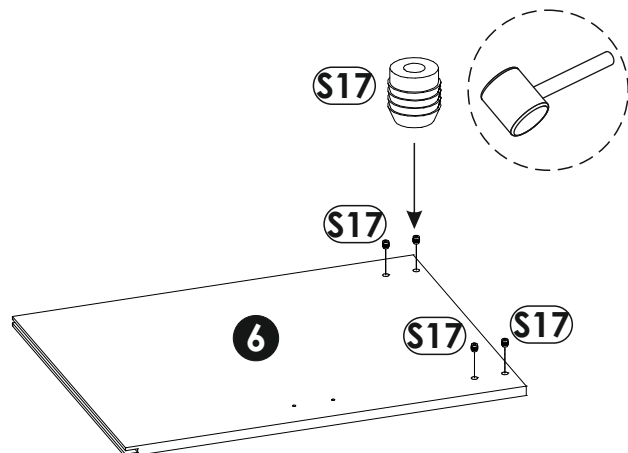
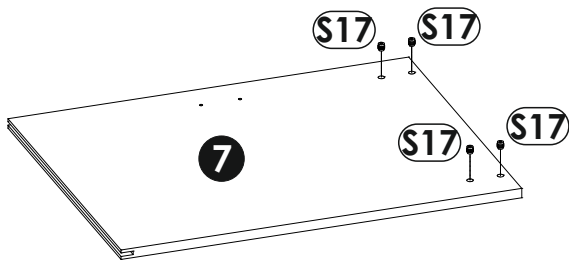
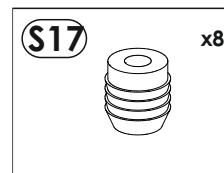
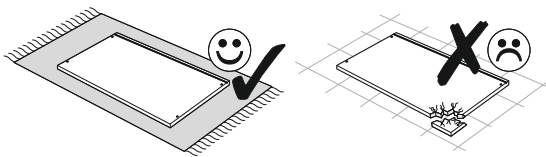

54▶

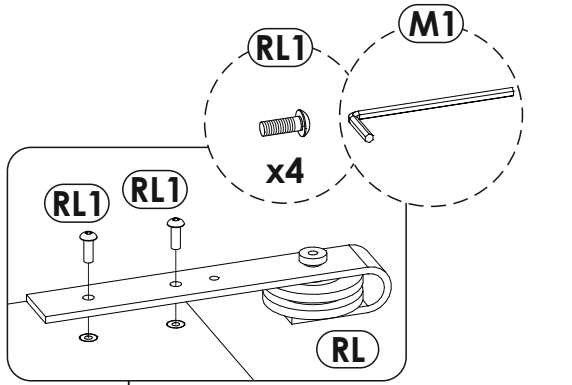
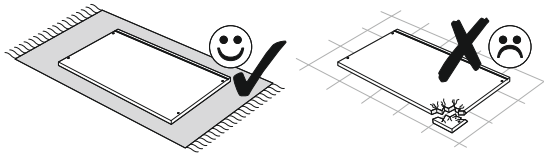

(N1) 3 X 16 mm x2	(RL) BE SC 14 28 00 x2
(RL1) x4	(Q1) x1

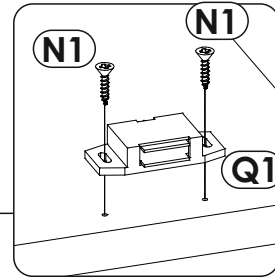
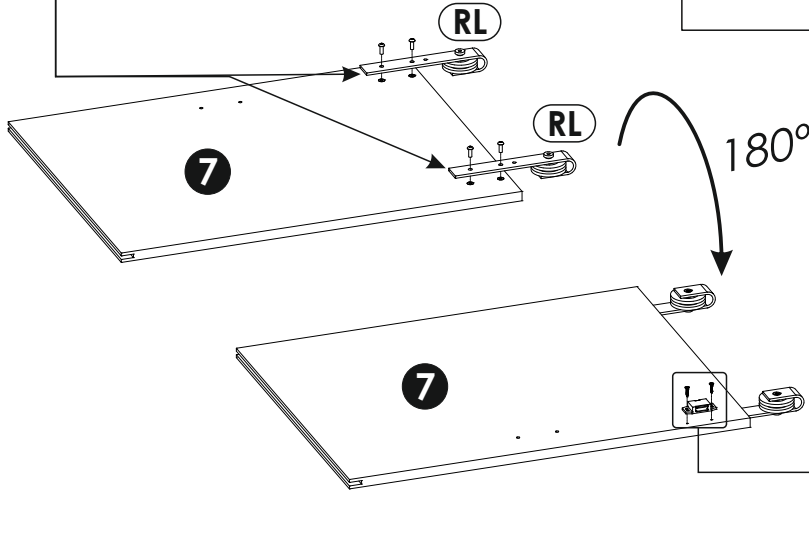

55▶

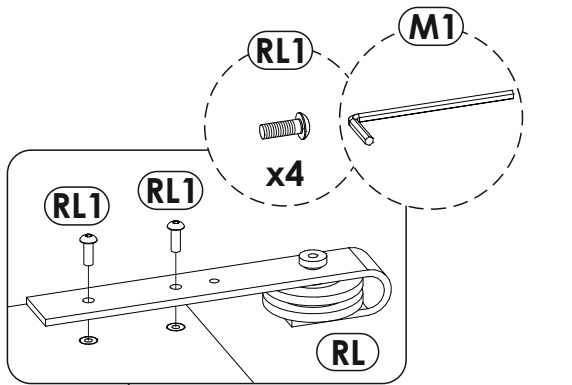
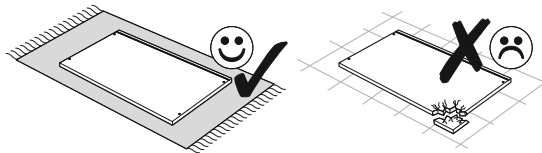

(N1) 3 X 16 mm x2	(RL) BE SC 14 28 00 x2
(RL1) x4	(Q1) x1

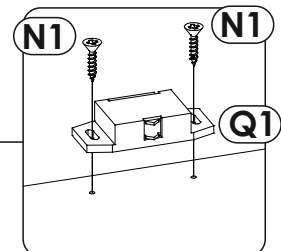
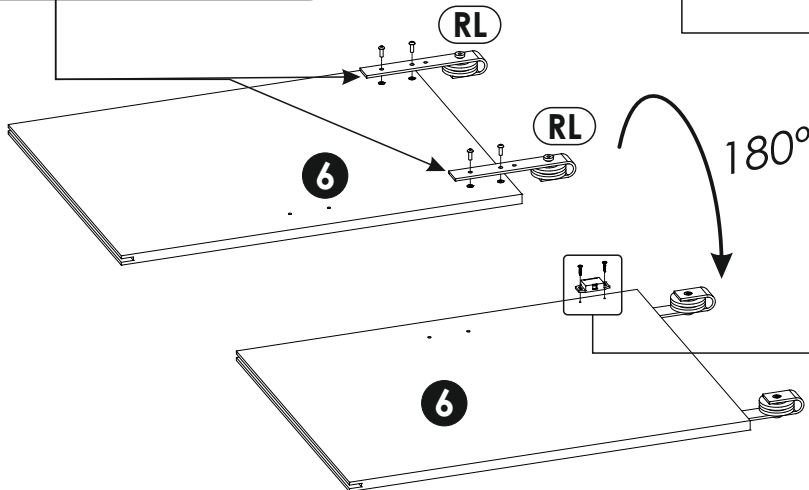

56▶

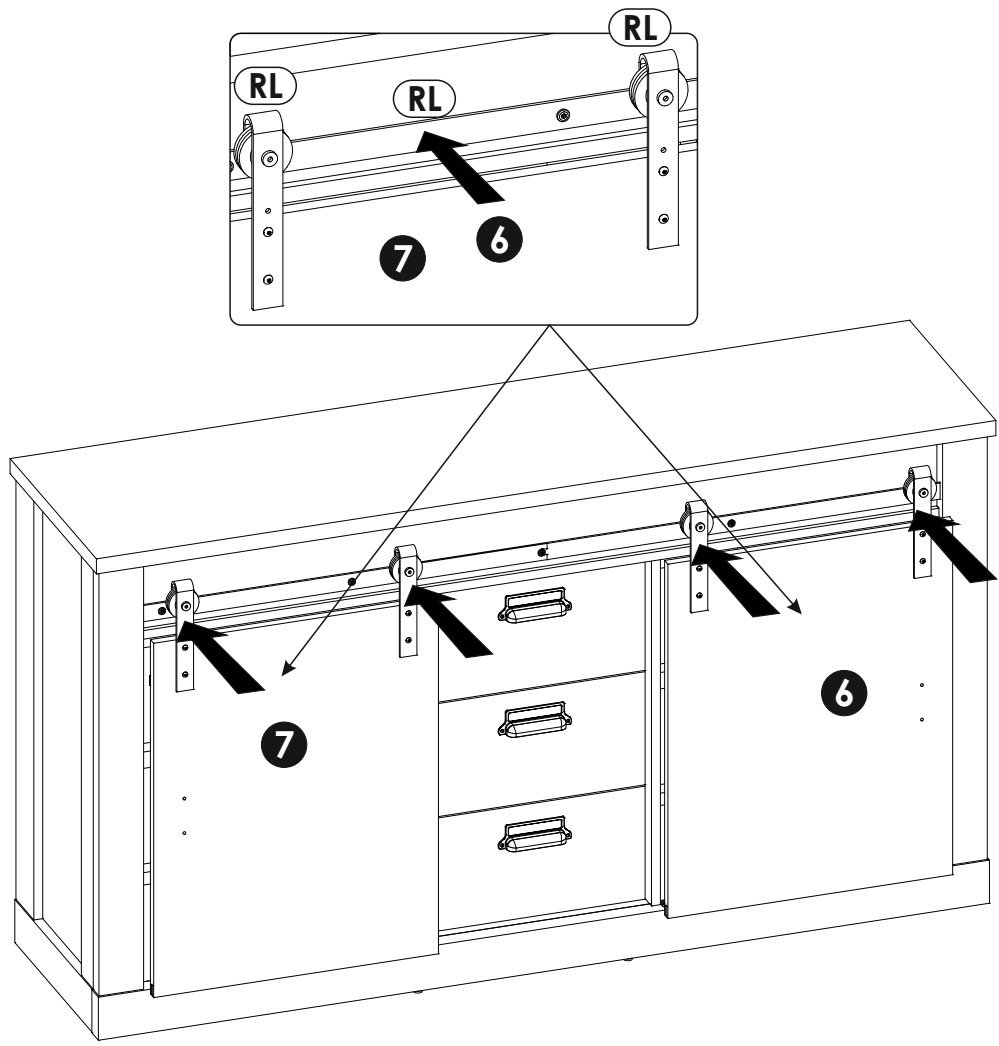

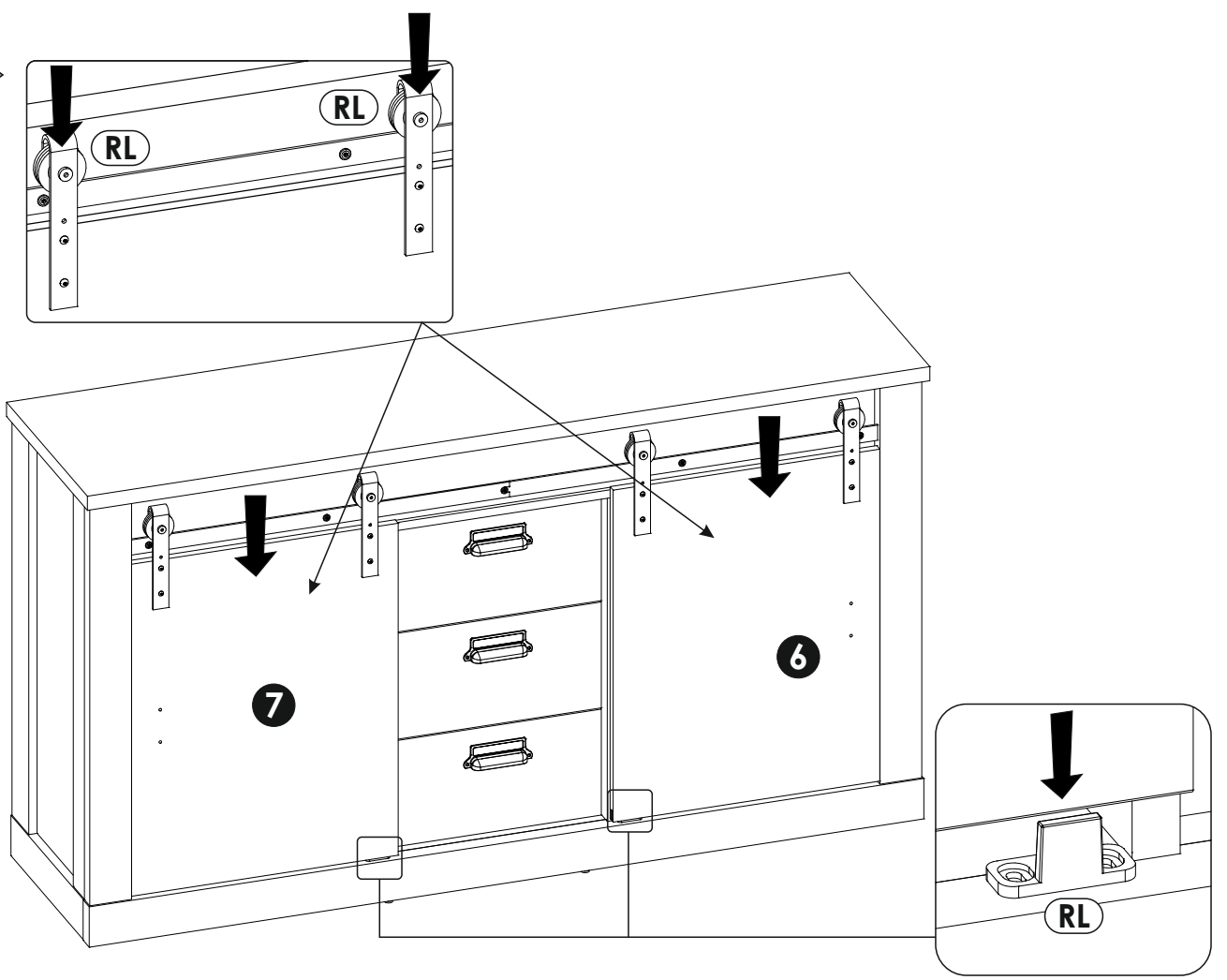

57▶

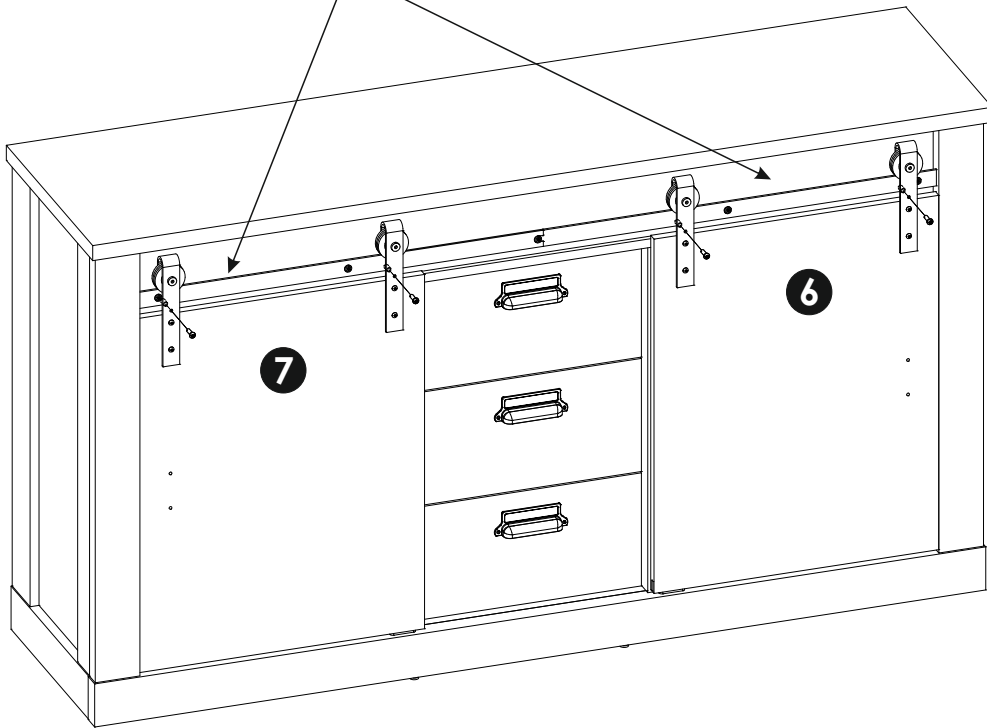
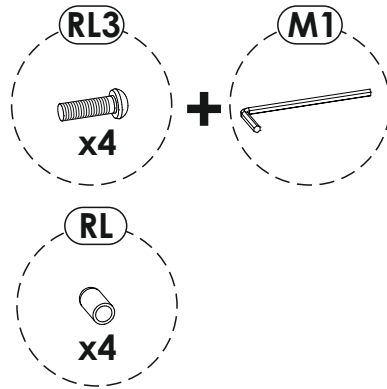
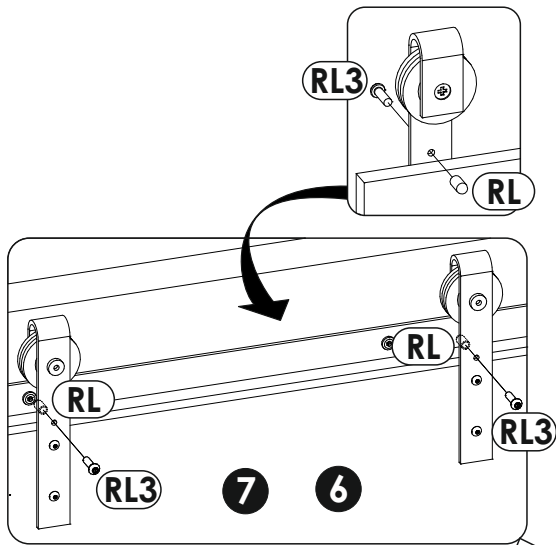
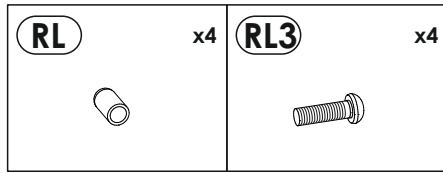

58▶



K3	x4	H2	x2
			
M4 x 22mm		L - 78 mm	

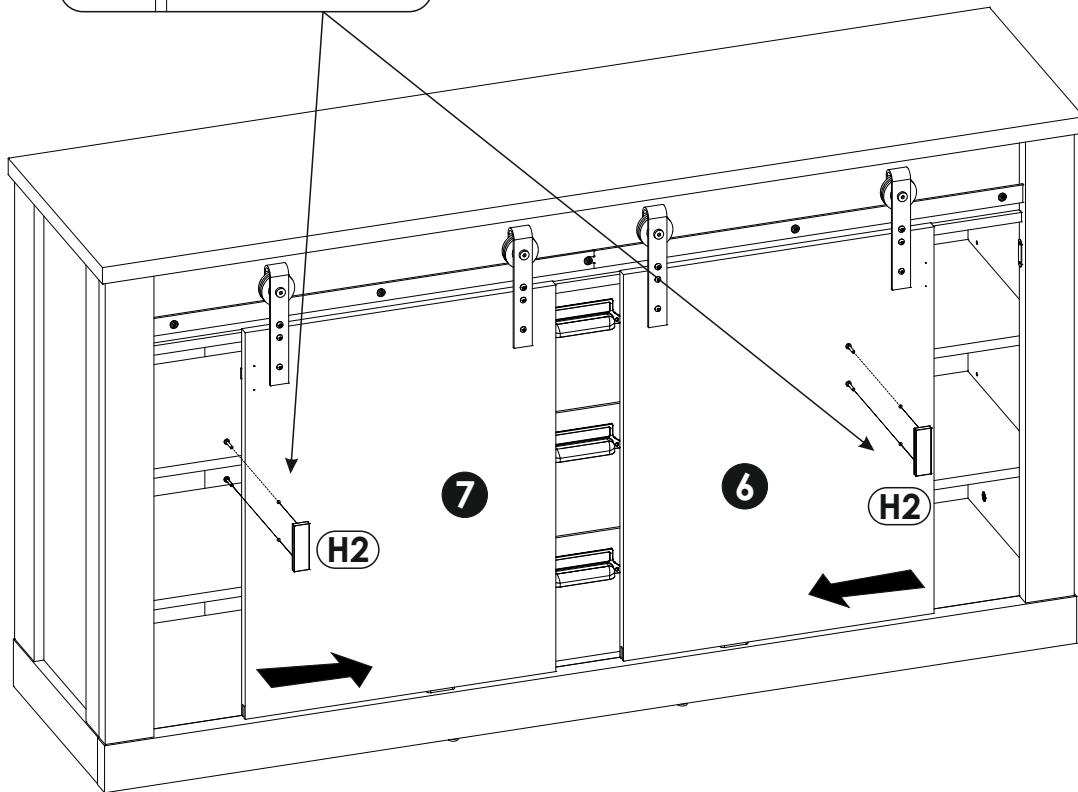
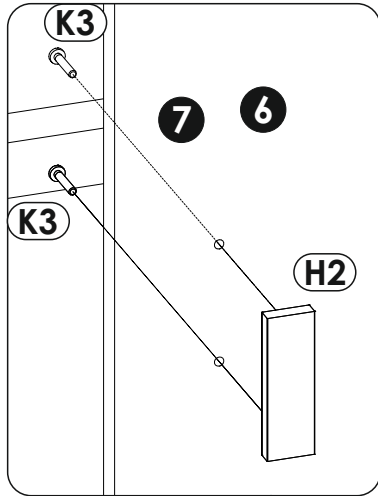

60▶

